

Capture

## Turnover Knives, Profile Knives, Knives

| Product  | Page |
|--|------|
| Turnover Knives, Profile Knives                        | 6-1  |
| Turnover Spurs   | 6-10 |
| Turnover Knives  | 6-12 |
| centering point  | 6-18 |
| Mini Turnover Knives                                   | 6-19 |
| Portable Planer Turnover Knives                        | 6-21 |
| Radius and Chamfering Turnover Knives / Profile Knives | 6-22 |
| Profile Knives / Turnover Knives                       | 6-31 |
| Profile Turnover Knives                                | 6-42 |
| Scraper Turnover Knives / Knives                       | 6-45 |
| Cup Knives   | 6-52 |
| Saw Teeth  | 6-53 |
| Planing Knives   | 6-54 |
| Blanks   | 6-59 |

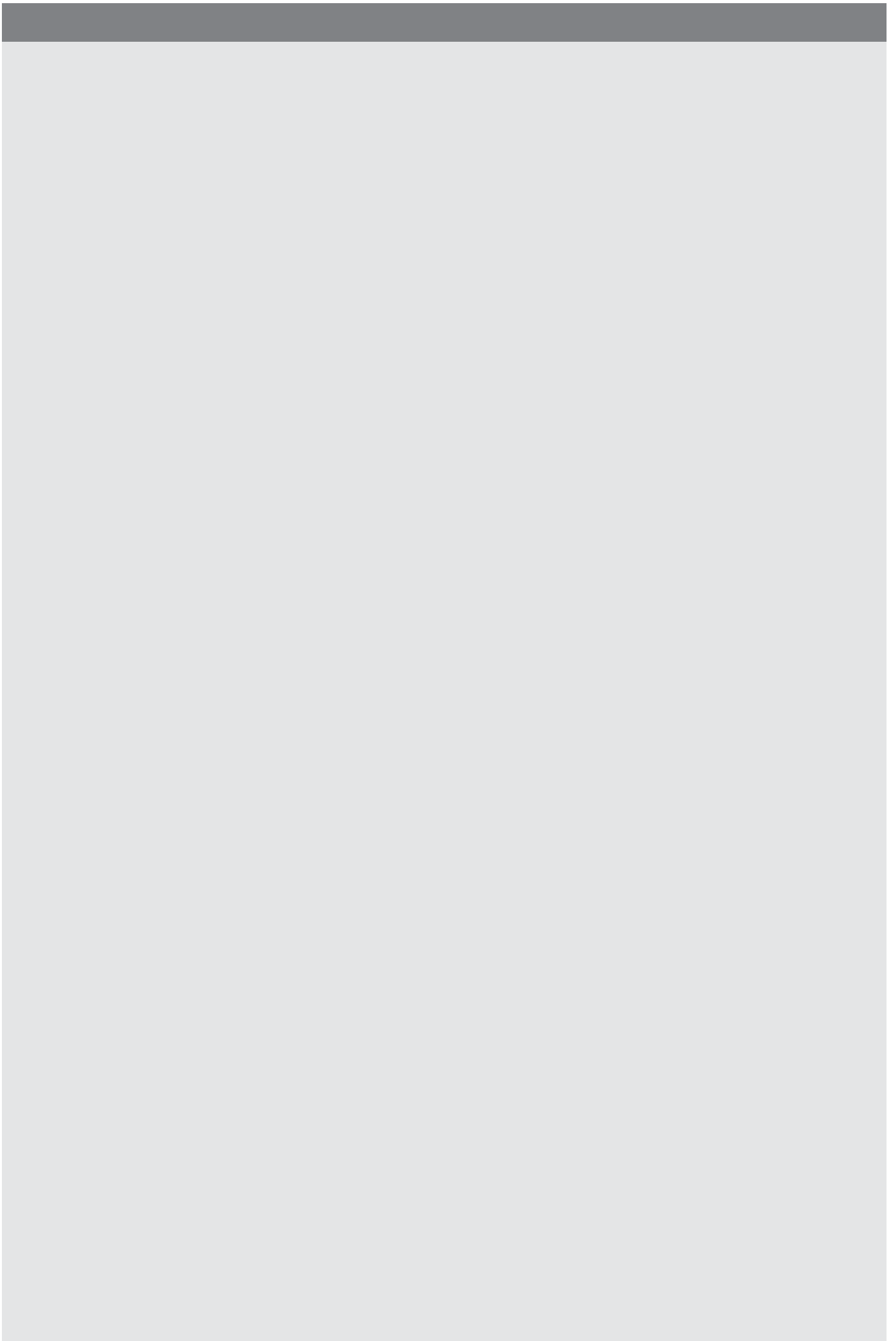

150511 / 150512 / 150515 / 150516 /

## Turnover Knives with 2 cutting edges

Product

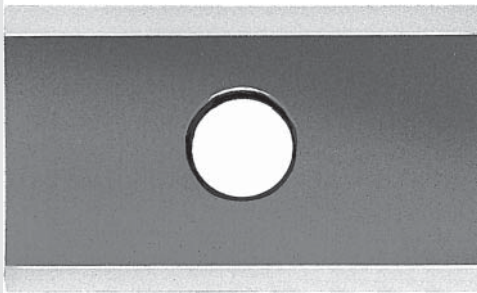

Drawing

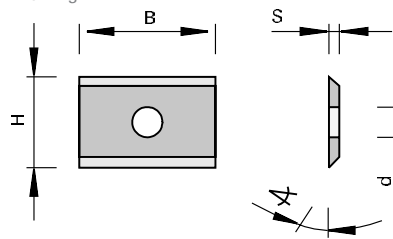
LEUCO  
DUR

Tungsten Carbide [HW]

Machine / Application

Design

- | Topline (polished face and micro-ground clearance angle)
- | cutting material: HW
- | HL Board 01 for wood-based panels and plastics
- | HL Board 02 for wood-based panels and plastics
- | HL Board 06 for wood-based panels, plastics, hard and soft woods
- | HW HL Board 05 for wood-based panels, plastics and hard woods
- | HW HL Solid 25 for hard and soft woods
- | HW HL Solid 25 Topline for hard and soft woods

Advantages

- | long edge life and optimum cutting quality in solid woods

Notes

- | packing unit: 10 pieces

| B    | H    | S    | Ø d  | wedge∠ | LEUCODUR            | Ident-No. |
|------|------|------|------|--------|---------------------|-----------|
| 7,6  | 12   | 1.5  | 4    | 55     | HL Board 05         | 052543    |
| 7,5  | 12   | 1.5  | 4    | 45     | HL Solid 25         | 173473 o  |
| 9,6  | 12   | 1.5  | 4    | 55     | HL Board 05         | 171163    |
| 10,5 | 12   | 1.5  | 4    | 55     | HL Board 05         | 162636    |
| 11   | 12   | 1.5  | 4    | 55     | HL Board 05         | 162637    |
| 12   | 12   | 1.5  | 4    | 45     | HL Solid 25         | 173466 o  |
| 13   | 12   | 1.5  | 4    | 55     | HL Board 05         | 162638    |
| 15   | 12   | 1.5  | 4    | 55     | HL Board 05         | 003081    |
| 15   | 12   | 1.5  | 4    | 45     | HL Solid 25         | 173467 o  |
| 15,7 | 12   | 1.5  | 4    | 55     | HL Board 05         | 163846    |
| 17   | 12   | 1.5  | 4    | 55     | HL Board 05         | 162639    |
| 18   | 12   | 1.5  | 4    | 55     | HL Board 05         | 162520    |
| 19   | 12   | 1.5  | 4    | 55     | HL Board 05         | 164242    |
| 20   | 12   | 1.5  | 4    | 55     | HL Board 01         | 180222    |
| 20   | 12   | 1.5  | 4    | 55     | HL Board 02         | 176469    |
| 20   | 12   | 1.5  | 4    | 55     | HL Board 06         | 178287    |
| 20   | 12   | 1.5  | 4    | 55     | HL Board 05         | 003082    |
| 20   | 12   | 1.5  | 4    | 45     | HL Solid 25         | 173468 o  |
| 20   | 12   | 1.5  | 4    | 45     | HL Solid 25 Topline | 176265    |
| [mm] | [mm] | [mm] | [mm] | [°]    |                     |           |

150511 / 150512 / 150515 / 150516 /

## Turnover Knives with 2 cutting edges

Product

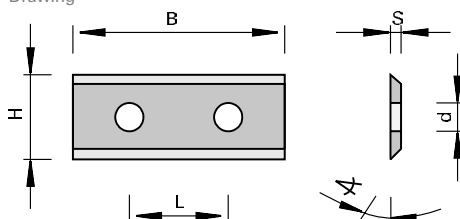

Drawing

LEUCO  
DUR

Tungsten Carbide [HW]

Machine / Application

Design

Advantages

Notes

- | Topline (polished face and micro-ground clearance angle)
- | cutting material: HW
- | HL Board 01 for wood-based panels and plastics
- | HL Board 02 for wood-based panels and plastics
- | HL Board 06 for wood-based panels, plastics, hard and soft woods
- | HL Board 05 for wood-based panels, plastics and hard woods
- | HL Solid 25 for hard and soft woods
- | HL Solid 25 Topline for hard and soft woods
- | HL Solid 30 for hard and soft woods

- | long edge lives and optimum cutting quality in solid woods

- | packing unit: 10 pieces

| B    | H    | S    | Ø d  | L    | wedge◁ | LEUCODUR            | Ident-No. |
|------|------|------|------|------|--------|---------------------|-----------|
| 30   | 12   | 1.5  | 4    | 14   | 55     | HL Board 01         | 180223    |
| 30   | 12   | 1.5  | 4    | 14   | 55     | HL Board 02         | 176470    |
| 30   | 12   | 1.5  | 4    | 14   | 55     | HL Board 06         | 178288    |
| 30   | 12   | 1.5  | 4    | 14   | 55     | HL Board 05         | 003083    |
| 30   | 12   | 1.5  | 4    | 14   | 45     | HL Solid 25         | 173469 o  |
| 30   | 12   | 1.5  | 4    | 14   | 45     | HL Solid 25 Topline | 176266    |
| 40   | 12   | 1.5  | 4    | 26   | 55     | HL Board 02         | 182191 o  |
| 40   | 12   | 1.5  | 4    | 26   | 55     | HL Board 05         | 164078    |
| 40   | 12   | 1.5  | 4    | 26   | 45     | HL Solid 25         | 173470 o  |
| 40   | 12   | 1.5  | 4    | 26   | 45     | HL Solid 25 Topline | 176267    |
| 50   | 12   | 1.5  | 4    | 26   | 55     | HL Board 01         | 180224    |
| 50   | 12   | 1.5  | 4    | 26   | 55     | HL Board 02         | 176471    |
| 50   | 12   | 1.5  | 4    | 26   | 55     | HL Board 06         | 178289    |
| 50   | 12   | 1.5  | 4    | 26   | 55     | HL Board 05         | 003085    |
| 50   | 12   | 1.5  | 4    | 26   | 45     | HL Solid 25 Topline | 176268    |
| 60   | 12   | 1.5  | 4    | 26   | 55     | HL Board 05         | 003086    |
| 60   | 12   | 1.5  | 4    | 26   | 45     | HL Solid 25         | 173472 o  |
| 60   | 12   | 1.5  | 4    | 26   | 45     | HL Solid 25 Topline | 176269 o  |
| 80   | 13   | 2.2  | 4    | 60   | 55     | HL Board 06         | 003087    |
| 80   | 13   | 2.2  | 4    | 60   | 45     | HL Solid 25 Topline | 181677    |
| 100  | 13   | 2.2  | 4    | 60   | 55     | HL Board 06         | 003088    |
| 120  | 13   | 2.2  | 4    | 60   | 55     | HL Board 06         | 003089    |
| [mm] | [mm] | [mm] | [mm] | [mm] | [°]    |                     |           |

150513 / 150515 150518 / 150718

## Turnover Knives with 2 cutting edges

Product

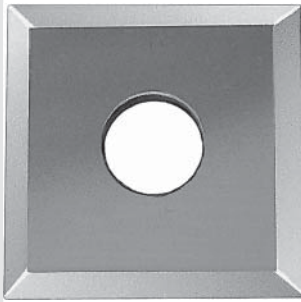

Drawing

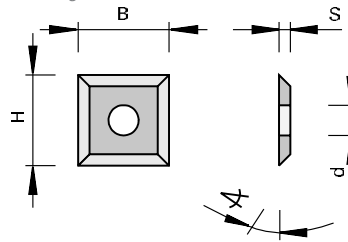
LEUCO  
DUR

Tungsten Carbide [HW]

Machine / Application

Design

- | Topline (polished face and micro-ground clearance angle)
- | cutting material: HW
- | HL Board 03 for wood-based panels and plastics
- | HL Board 05 for wood-based panels, plastics and hard woods
- | HL Solid 25 Topline for hard and soft woods
- | HL Solid 30 for hard and soft woods

Advantages

- | long edge lives and optimum cutting quality in solid woods

Notes

- | packing unit: 10 pieces

| B    | H    | S    | Ø d  | wedge< | LEUCODUR            | Ident-No. |
|------|------|------|------|--------|---------------------|-----------|
| 10,5 | 10,5 | 1,5  | 4    | 55     | HL Solid 30         | 162316    |
| 12   | 12   | 1,5  | 4    | 55     | HL Board 03         | 180820    |
| 12   | 12   | 1,5  | 4    | 55     | HL Board 05         | 003080    |
| 12   | 12   | 1,5  | 4    | 45     | HL Solid 25 Topline | 176340    |
| 17   | 17   | 2    | 4    | 55     | HL Board 05         | 162581    |
| 19   | 19   | 2    | 4    | 55     | HL Board 05         | 162582    |
| [mm] | [mm] | [mm] | [mm] | [°]    |                     |           |

150515

## Turnover Knives with 2 cutting edges, end sharpened

Product

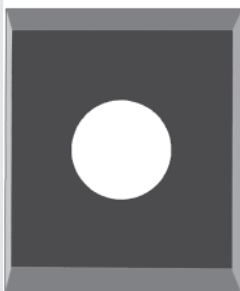

Drawing

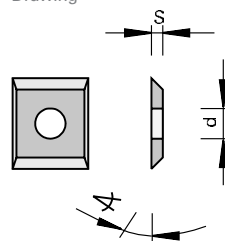
LEUCO  
DUR

Tungsten Carbide [HW]

Machine / Application

Design

- | cutting material: HW
- | HL Board 05 for wood-based panels, plastics and hard woods

Advantages

Notes

- | packing unit: 10 pieces

| B    | H    | S    | Ø d  | wedge< | LEUCODUR    | Ident-No. |
|------|------|------|------|--------|-------------|-----------|
| 7,5  | 12   | 1,5  | 4    | 55     | HL Board 05 | 167256    |
| 10   | 12   | 1,5  | 4    | 55     | HL Board 05 | 165914    |
| [mm] | [mm] | [mm] | [mm] | [°]    |             |           |

150516 / 150513

### Turnover Knives with 2 cutting edges, end sharpened

Product

Drawing

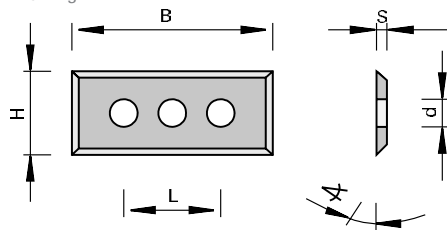

Tungsten Carbide [HW]

Machine / Application

Design

Advantages

Notes

- | cutting material: HW
- | HL Board 06 for wood-based panels, plastics and soft woods
- | HL Board 03 for wood-based panels and plastics

| packing unit: 10 pieces

| B    | H    | S    | Ø d  | L    | wedge∠ | LEUCODUR    | Ident-No. |
|------|------|------|------|------|--------|-------------|-----------|
| 50   | 12   | 1.7  | 4    | 37   | 55     | HL Board 06 | 179994    |
| 50   | 12   | 1.7  | 4    | 37   | 55     | HL Board 03 | 182456    |
| [mm] | [mm] | [mm] | [mm] | [mm] | [°]    |             |           |

150515

### Turnover Knives with 2 cutting edges and chamfer - HOLZ-HER

Product

Drawing

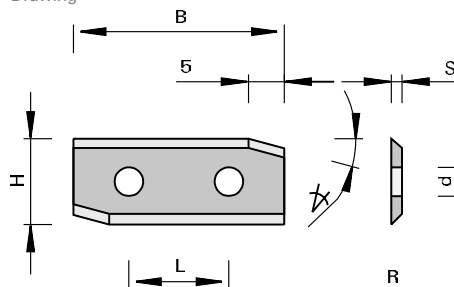

Tungsten Carbide [HW]

Machine / Application

Design

Advantages

Notes

- | machines HOLZ-HER
- | for use in edge banding / jointing cutterheads

- | grinding angle 55 degrees
- | cutting material: HW
- | HL Board 05 for wood-based panels, plastics and hard woods

| packing unit: 10 pieces

| chamfer∠ | B    | H    | S    | Ø d  | L    | Ident-No. [L] | Ident-No. [R] |
|----------|------|------|------|------|------|---------------|---------------|
| 15       | 29,5 | 12   | 1.5  | 4    | 14   | 160118        | 160618        |
| [°]      | [mm] | [mm] | [mm] | [mm] | [mm] |               |               |

150515

## Turnover Knives with 2 cutting edges, edge bevel and end sharpened

Product

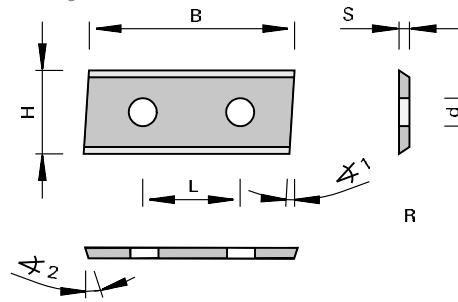

Drawing

LEUCO  
DUR

Tungsten Carbide [HW]

Notes

| packing unit: 10 pieces

Machine / Application

| for use in V-grooving cutter-  
heads and prism cutterheads

Design

- | grinding angle 55 degrees
- | cutting material: HW
- | HL Board 05 for wood-based panels, plastics and hard woods

Advantages

| B    | H    | S    | Ø d  | L    | Frei∠ 1 | Frei∠ 2 | Ident-No. [L] | Ident-No. [R] |
|------|------|------|------|------|---------|---------|---------------|---------------|
| 19,5 | 12   | 1.5  | 4    |      | 3.5     | 10      | 160626        | 160625        |
| 29,5 | 12   | 1.5  | 4    | 14   | 5       |         | 003119        | 003118        |
| 49,2 | 12   | 1.5  | 4    | 26   | 5       |         | 003121        | 003120        |
| [mm] | [mm] | [mm] | [mm] | [mm] | [°]     | [°]     |               |               |

150513 / 150515

## Turnover Knives with 2 cutting edges, end sharpened

Product

Drawing

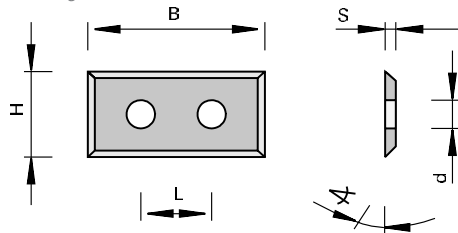
LEUCO  
DUR

Tungsten Carbide [HW]

Notes

| packing unit: 10 pieces

Machine / Application

| for use in shank-type cutters

Design

- | cutting material: HW
- | HL Board 02 for wood-based panels and plastics
- | HL Board 03 for wood-based panels and plastics
- | HL Board 05 for wood-based panels, plastics and hard woods

Advantages

| B    | H    | S    | Ø d  | L    | wedge∠ | LEUCODUR    | Ident-No. |
|------|------|------|------|------|--------|-------------|-----------|
| 30   | 9    | 1.5  | 3,7  | 14   | 55     | HL Board 03 | 180807    |
| 30   | 9    | 1.5  | 3,7  | 14   | 55     | HL Board 05 | 180821 o  |
| 40   | 9    | 1.5  | 3,7  | 26   | 55     | HL Board 05 | 180815    |
| 50   | 9    | 1.5  | 3,7  | 26   | 55     | HL Board 03 | 180808    |
| 50   | 9    | 1.5  | 3,7  | 26   | 55     | HL Board 05 | 180806    |
| 29,5 | 12   | 1.5  | 4    | 14   | 55     | HL Board 02 | 181160    |
| 29,5 | 12   | 1.5  | 4    | 14   | 55     | HL Board 05 | 180825    |
| 39,5 | 12   | 1.5  | 4    | 26   | 55     | HL Board 05 | 171149    |
| 49,5 | 12   | 1.5  | 4    | 26   | 55     | HL Board 05 | 180826    |
| [mm] | [mm] | [mm] | [mm] | [mm] | [°]    |             |           |

150513

### Turnover Knives with 2 cutting edges, end sharpened

Product

Drawing

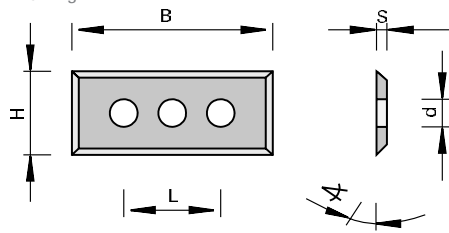

Tungsten Carbide [HW]

Machine / Application

| for use in shank-type cutters

Design

| cutting material: HW  
| HL Board 03 for wood-based panels and plastics

Advantages

Notes

| packing unit: 10 pieces

| B    | H    | S    | Ø d  | L    | wedge◁ | Ident-No. |
|------|------|------|------|------|--------|-----------|
| 50   | 9    | 1.5  | 3,7  | 37   | 55     | 181982    |
| [mm] | [mm] | [mm] | [mm] | [mm] | [°]    |           |

150515

### Turnover Knives with 2 cutting edges

Product

Drawing

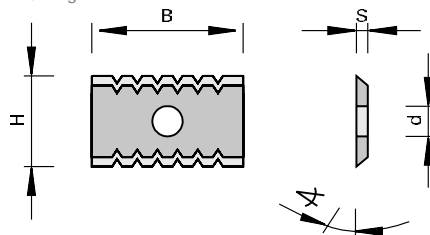
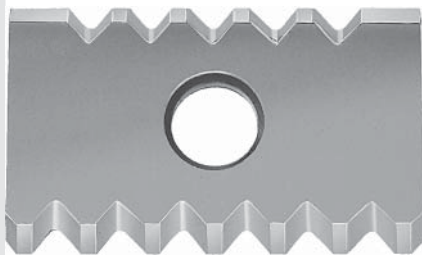

Tungsten Carbide [HW]

Machine / Application

| for use in hoggers

Design

| chip breakers for optimum cut division  
| cutting material: HW  
| HL Board 05 for wood-based panels, plastics and hard woods

Advantages

Notes

| packing unit: 10 pieces

| B    | H    | S    | Ø d  | wedge◁ | Ident-No. |
|------|------|------|------|--------|-----------|
| 20   | 12   | 1.5  | 4    | 55     | 055905    |
| [mm] | [mm] | [mm] | [mm] | [°]    |           |



150518

## Turnover Knives with 2 cutting edges

Product

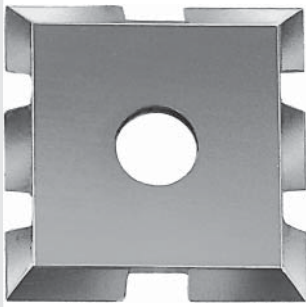

Drawing

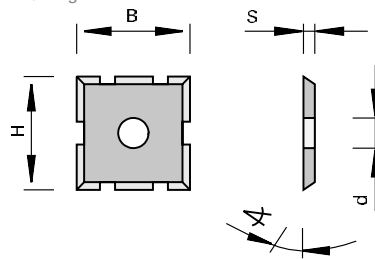

Tungsten Carbide [HW]

Machine / Application

Design

Advantages

Notes

- | chip breakers for optimum cut division
- | cutting material: HW
- | HL Solid 25 for hard and soft woods

| packing unit: 10 pieces

| B    | H    | S    | Ø d  | wedge∠ | Ident-No. |
|------|------|------|------|--------|-----------|
| 15   | 15   | 2    | 4    | 55     | 167873    |
| [mm] | [mm] | [mm] | [mm] | [°]    |           |

150523

## Profile Knives with 1 cutting edge, end sharpened

Product

Drawing

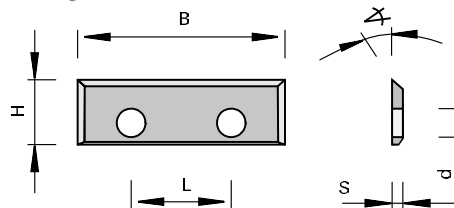

Tungsten Carbide [HW]

Machine / Application

Design

Advantages

Notes

| for use in shank-type cutters

- | cutting material: HW
- | HL Board O3 for wood-based panels and plastics

| packing unit: 10 pieces

| B    | H    | S    | Ø d  | L    | wedge∠ | Ident-No. |
|------|------|------|------|------|--------|-----------|
| 16   | 7    | 1.5  | 3,4  | 7    | 55     | 180262    |
| 28   | 7    | 1.5  | 3,4  | 14   | 55     | 180260    |
| [mm] | [mm] | [mm] | [mm] | [mm] | [°]    |           |

150515

### Turnover Knives with 2 cutting edges

Product



Drawing

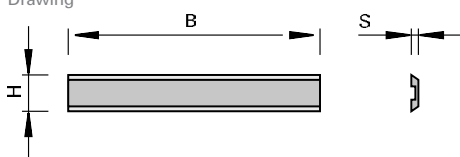

Tungsten Carbide [HW]

Machine / Application

l for use in Leitz cutterheads

Design

l cutting material: HW HL Board  
05 for wood-based panels,  
plastics and hard woods

Advantages

Notes

| B    | H    | S    | Ident-No. |
|------|------|------|-----------|
| 14,7 | 8    | 1.5  | 181504    |
| 19,7 | 8    | 1.5  | 181505    |
| 30   | 8    | 1.5  | 181506    |
| 35   | 8    | 1.5  | 181507    |
| 40   | 8    | 1.5  | 181508    |
| 50   | 8    | 1.5  | 181509    |
| 60   | 8    | 1.5  | 181510    |
| 80   | 8    | 1.5  | 181511    |
| [mm] | [mm] | [mm] |           |

150518 / 150519

### Turnover Knives with 2 cutting edges

Product



Drawing

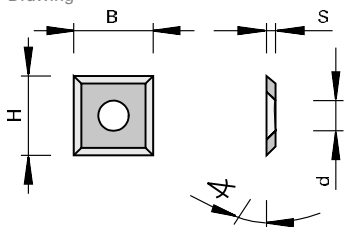

Tungsten Carbide [HW]

Machine / Application

l machines Hundegger  
l for use in cutterheads

Design

l cutting material: HW  
l HL Solid 60 for soft woods  
l HL Solid 30 for hard and soft  
woods

Advantages

Notes

l packing unit: 10 pieces

| B    | H    | S    | Ø d  | wedge | LEUCODUR    | Ident-No. |
|------|------|------|------|-------|-------------|-----------|
| 21   | 21   | 5.5  | 7,3  | 40    | HL Solid 30 | 180639    |
| 21   | 21   | 5.5  | 7,3  | 40    | HL Solid 60 | 180638    |
| [mm] | [mm] | [mm] | [mm] | [°]   |             |           |

150518 / 150519

## Turnover Knives with 2 cutting edges and counter sink

Product

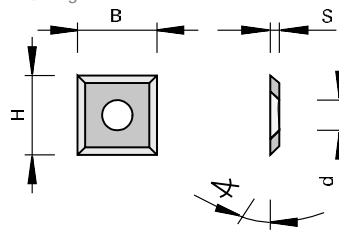

Drawing

LEUCO  
DUR

Tungsten Carbide [HW]

Machine / Application

Design

Advantages

Notes

| 0

| for use in edge jointing  
cutterheads

| for use in spiral cutterheads

| for use in cutterheads

| packing unit: 10 pieces

| B    | H    | S    | Ø d  | wedge | LEUCODUR    |                       | Ident-No. |
|------|------|------|------|-------|-------------|-----------------------|-----------|
| 13,6 | 13,6 | 2    | 6,3  | 45    | HL Solid 40 | Fischer Brugg         | 163829    |
| 14,3 | 14,3 | 2,5  | 6,3  | 55    | HL Solid 25 | Homag                 | 170248    |
| 15   | 15   | 2,5  | 6,2  | 50    | HL Solid 25 | Chamfering Cutterhead | 181243    |
| 15   | 15   | 2,5  | 6,4  | 60    | HL Solid 25 | with rounded edges    | 180454    |
| 20   | 14,3 | 2,5  | 6,3  | 55    | HL Solid 15 | Homag                 | 168509    |
| [mm] | [mm] | [mm] | [mm] | [°]   |             |                       |           |

150558

### Triangular Spur with 3 cutting edges

Product

Drawing

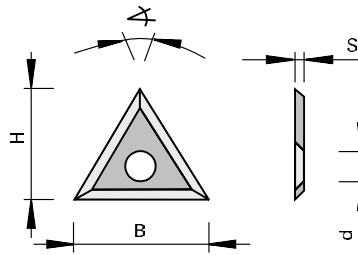

Tungsten Carbide [HW]

Machine / Application

| for use in Leitz cutterheads

Design

| cutting material: HW  
| HL Solid 25 for hard and soft woods

Advantages

Notes

| packing unit: 10 pieces

| B    | H     | S    | Ø d  | corner∟ | LEUCODUR    | Ident-No. |
|------|-------|------|------|---------|-------------|-----------|
| 22   | 19.05 | 2    | 6,5  | 60      | HL Solid 25 | 180779    |
| [mm] | [mm]  | [mm] | [mm] | [°]     |             |           |

150553 / 150555 / 150759 / 150758

### Turnover Spur with 4 cutting edges and counter sink

Product

Drawing

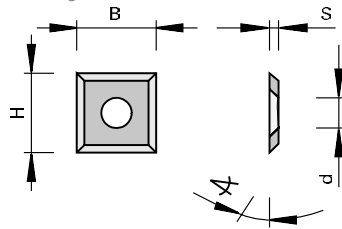
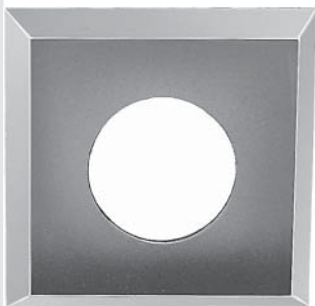

Tungsten Carbide [HW]

Machine / Application

| for use in cutterheads

Design

| Topline (polished face and micro-ground clearance angle)

Advantages

| long edge life and optimum cutting quality specifically in solid woods thanks to Topline design

Notes

| Ident-No. 167777 for scoring device of the HOLZ-HER vertical panel sizing saw  
| \* marking for easier mounting  
| packing unit: 10 pieces

| B    | H    | S    | Ø d  | wedge∟ | LEUCODUR            | Ident-No.          |
|------|------|------|------|--------|---------------------|--------------------|
| 14   | 14   | 1.2  | 8,6  | 60     | HL Solid 40         | 163701             |
| 14   | 14   | 1.2  | 8,6  | 60     | HL Solid 40         | HOLZ-HER<br>167777 |
| 14   | 14   | 2    | 6,3  | 60     | HL Solid 25 Topline | 176341             |
| 14   | 14   | 2    | 6,3  | 60     | HL Solid 40         | 003079             |
| 14   | 14   | 2    | 6,3  | 60     | HL Board 05         | 180954             |
| 14   | 14   | 2    | 6,3  | 60     | HL Board 03         | 180646             |
| [mm] | [mm] | [mm] | [mm] | [°]    |                     |                    |

150558

### Turnover Spur with 4 cutting edges and counter sink - Lestro

Product

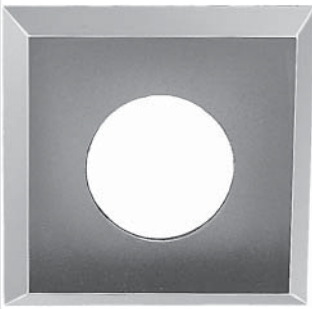

Drawing

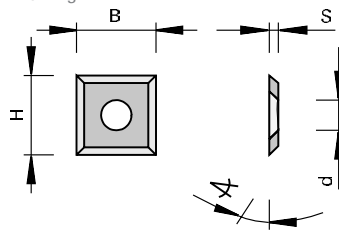

Tungsten Carbide [HW]

Machine / Application

l machines Lestro  
l for use in cutterheads

Design

Advantages

Notes

l packing unit: 10 pieces

| B    | H    | S    | Ø d  | wedge | LEUCODUR    | Ident-No. |
|------|------|------|------|-------|-------------|-----------|
| 10,5 | 10,5 | 1,5  | 4    | 55    | HL Solid 25 | Lestro    |
| [mm] | [mm] | [mm] | [mm] | [°]   |             |           |

150558

### Turnover Spurs

Product



Drawing

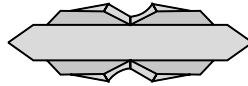

Tungsten Carbide [HW]

Machine / Application

Design

l cutting edge with scoring cut  
l cutting material: HW  
l HL Solid 15 for wood-based panels, hard and soft woods

Advantages

l chip-free hole edges thanks to cutting edge with scoring cut

Notes

l packing unit: 10 pieces

| Ident-No. |
|-----------|
| 181263    |

150518

### Turnover Knives HW with 2 cutting edges - Weingig

Product

Drawing

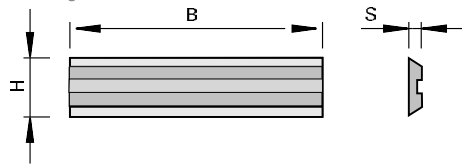

Tungsten Carbide [HW]

Machine / Application

l for use in Weingig planing cutterheads Centrolock for planing of glued soft woods, hard woods and MDF

Design

l cutting material: HW  
l HL Solid 25 for hard and soft woods

Advantages

l high planing quality and long edge lives

Notes

l packing unit: 2 pieces

| B    | H    | S    | Ident-No. |
|------|------|------|-----------|
| 20   | 16   | 3    | 181593 o  |
| 60   | 16   | 3    | 181594 o  |
| 80   | 16   | 3    | 181595 o  |
| 100  | 16   | 3    | 181596    |
| 130  | 16   | 3    | 181597    |
| 150  | 16   | 3    | 181598 o  |
| 170  | 16   | 3    | 181599    |
| 180  | 16   | 3    | 181600 o  |
| 190  | 16   | 3    | 181601 o  |
| 210  | 16   | 3    | 181602 o  |
| 230  | 16   | 3    | 181603 o  |
| 240  | 16   | 3    | 181604    |
| 260  | 16   | 3    | 181605 o  |
| 270  | 16   | 3    | 181606 o  |
| 310  | 16   | 3    | 181607 o  |
| 460  | 16   | 3    | 181608 o  |
| [mm] | [mm] | [mm] |           |

332121

### Turnover Knives HS with 2 cutting edges

Product

Drawing

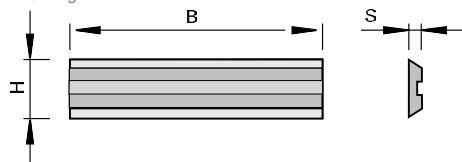

High Speed Steel [HS]

Machine / Application

l for use in Weingig planing cutterheads Centrolock for planing of soft woods

Design

l cutting material: HS for soft woods

Advantages

l high planing quality and long edge lives

Notes

l packing unit: 2 pieces

| B    | H    | S    | Ident-No. |
|------|------|------|-----------|
| 20   | 16   | 3    | 181804 o  |
| 60   | 16   | 3    | 181805 o  |
| 80   | 16   | 3    | 181806 o  |
| [mm] | [mm] | [mm] |           |

| B    | H    | S    | Ident-No. |
|------|------|------|-----------|
| 100  | 16   | 3    | 181807 o  |
| 130  | 16   | 3    | 181808    |
| 150  | 16   | 3    | 181809 o  |
| 170  | 16   | 3    | 181810    |
| 180  | 16   | 3    | 181811 o  |
| 190  | 16   | 3    | 181812 o  |
| 210  | 16   | 3    | 181813 o  |
| 230  | 16   | 3    | 181814 o  |
| 240  | 16   | 3    | 181815    |
| 260  | 16   | 3    | 181816 o  |
| 270  | 16   | 3    | 181817 o  |
| 310  | 16   | 3    | 181818 o  |
| 460  | 16   | 3    | 181819 o  |
| [mm] | [mm] | [mm] |           |

332751

## Turnover Knives SP with 2 cutting edges

Product

Drawing

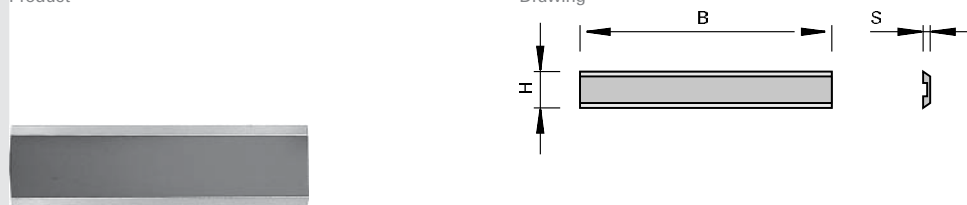

Alloyed Steel

Machine / Application

Design

Advantages

Notes

l for use in Tersa planing  
cutterheads

l SP - 13% chrome - special steel

| B    | H    | S    | Ident-No. |
|------|------|------|-----------|
| 60   | 10   | 3    | 175405 o  |
| 70   | 10   | 3    | 175406 o  |
| 80   | 10   | 3    | 175407 o  |
| 90   | 10   | 3    | 175408 o  |
| 100  | 10   | 3    | 175409 o  |
| 110  | 10   | 3    | 175410 o  |
| 120  | 10   | 3    | 175411 o  |
| 130  | 10   | 3    | 175412 o  |
| 140  | 10   | 3    | 175413 o  |
| 150  | 10   | 3    | 175414 o  |
| 160  | 10   | 3    | 175415 o  |
| 170  | 10   | 3    | 175416 o  |
| 180  | 10   | 3    | 175417 o  |
| 185  | 10   | 3    | 175418 o  |
| 190  | 10   | 3    | 175419 o  |
| 200  | 10   | 3    | 175420 o  |
| 210  | 10   | 3    | 175421 o  |
| 220  | 10   | 3    | 175422 o  |
| 230  | 10   | 3    | 175423 o  |
| 240  | 10   | 3    | 175424 o  |
| 250  | 10   | 3    | 175425 o  |
| 260  | 10   | 3    | 175426 o  |
| 265  | 10   | 3    | 175427 o  |
| 270  | 10   | 3    | 175428 o  |
| 280  | 10   | 3    | 175429 o  |
| 290  | 10   | 3    | 175430 o  |
| 300  | 10   | 3    | 175431 o  |
| [mm] | [mm] | [mm] |           |

## Turnover Knives

| B    | H    | S    | Ident-No. |
|------|------|------|-----------|
| 310  | 10   | 3    | 175432 o  |
| 315  | 10   | 3    | 175433 o  |
| 320  | 10   | 3    | 175434 o  |
| 330  | 10   | 3    | 175435 o  |
| 340  | 10   | 3    | 175436 o  |
| 350  | 10   | 3    | 175437 o  |
| 360  | 10   | 3    | 175438 o  |
| 370  | 10   | 3    | 175439 o  |
| 380  | 10   | 3    | 175440 o  |
| 390  | 10   | 3    | 175441 o  |
| 400  | 10   | 3    | 175442 o  |
| 410  | 10   | 3    | 175443 o  |
| 420  | 10   | 3    | 175444 o  |
| 430  | 10   | 3    | 175445 o  |
| 440  | 10   | 3    | 175446 o  |
| 450  | 10   | 3    | 175447 o  |
| 460  | 10   | 3    | 175448 o  |
| 470  | 10   | 3    | 175449 o  |
| 480  | 10   | 3    | 175450 o  |
| 490  | 10   | 3    | 175451 o  |
| 500  | 10   | 3    | 175452 o  |
| 510  | 10   | 3    | 175453 o  |
| 520  | 10   | 3    | 175454 o  |
| 530  | 10   | 3    | 175455 o  |
| 540  | 10   | 3    | 175456 o  |
| 550  | 10   | 3    | 175457 o  |
| 560  | 10   | 3    | 175458 o  |
| 570  | 10   | 3    | 175459 o  |
| 580  | 10   | 3    | 175460 o  |
| 590  | 10   | 3    | 175461 o  |
| 600  | 10   | 3    | 175462 o  |
| 610  | 10   | 3    | 175463 o  |
| 620  | 10   | 3    | 175464 o  |
| 630  | 10   | 3    | 175465 o  |
| 635  | 10   | 3    | 175466 o  |
| 637  | 10   | 3    | 175467 o  |
| 640  | 10   | 3    | 175468    |
| 650  | 10   | 3    | 175469 o  |
| [mm] | [mm] | [mm] |           |

332751

## Turnover Knives HS with 2 cutting edges

Product



Drawing

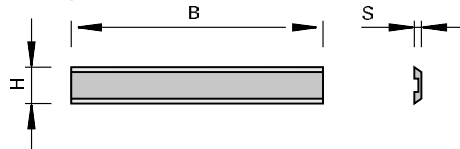

High Speed Steel [HS]

Machine / Application

l for use in Tersa planing  
cutterheads

Design

l cutting material: HS

Advantages

Notes

| B    | H    | S    | Ident-No. |
|------|------|------|-----------|
| 60   | 10   | 3    | 175305 o  |
| 70   | 10   | 3    | 175306 o  |
| [mm] | [mm] | [mm] |           |



| B    | H    | S    | Ident-No. |
|------|------|------|-----------|
| 80   | 10   | 3    | 175307 o  |
| 90   | 10   | 3    | 175308 o  |
| 100  | 10   | 3    | 175309 o  |
| 110  | 10   | 3    | 175310 o  |
| 120  | 10   | 3    | 175311 o  |
| 130  | 10   | 3    | 175312 o  |
| 140  | 10   | 3    | 175313 o  |
| 150  | 10   | 3    | 175314 o  |
| 160  | 10   | 3    | 175315 o  |
| 170  | 10   | 3    | 175316 o  |
| 180  | 10   | 3    | 175317 o  |
| 185  | 10   | 3    | 175318 o  |
| 190  | 10   | 3    | 175319 o  |
| 200  | 10   | 3    | 175320 o  |
| 210  | 10   | 3    | 175321 o  |
| 220  | 10   | 3    | 175322 o  |
| 230  | 10   | 3    | 175323 o  |
| 240  | 10   | 3    | 175324 o  |
| 250  | 10   | 3    | 175325 o  |
| 260  | 10   | 3    | 175326 o  |
| 265  | 10   | 3    | 175327 o  |
| 270  | 10   | 3    | 175328 o  |
| 280  | 10   | 3    | 175329 o  |
| 290  | 10   | 3    | 175330 o  |
| 300  | 10   | 3    | 175331 o  |
| 310  | 10   | 3    | 175332    |
| 315  | 10   | 3    | 175333 o  |
| 320  | 10   | 3    | 175334 o  |
| 330  | 10   | 3    | 175335 o  |
| 340  | 10   | 3    | 175336 o  |
| 350  | 10   | 3    | 175337 o  |
| 360  | 10   | 3    | 175338 o  |
| 370  | 10   | 3    | 175339 o  |
| 380  | 10   | 3    | 175340 o  |
| 390  | 10   | 3    | 175341 o  |
| 400  | 10   | 3    | 175342 o  |
| 410  | 10   | 3    | 175343    |
| 420  | 10   | 3    | 175344 o  |
| 430  | 10   | 3    | 175345 o  |
| 440  | 10   | 3    | 175346 o  |
| 450  | 10   | 3    | 175347 o  |
| 460  | 10   | 3    | 175348 o  |
| 470  | 10   | 3    | 175349 o  |
| 480  | 10   | 3    | 175350 o  |
| 490  | 10   | 3    | 175351 o  |
| 500  | 10   | 3    | 175352 o  |
| 510  | 10   | 3    | 175353    |
| 520  | 10   | 3    | 175354    |
| 530  | 10   | 3    | 175355 o  |
| 540  | 10   | 3    | 175356 o  |
| 550  | 10   | 3    | 175357 o  |
| 560  | 10   | 3    | 175358 o  |
| 570  | 10   | 3    | 175359 o  |
| 580  | 10   | 3    | 175360 o  |
| 590  | 10   | 3    | 175361 o  |
| 600  | 10   | 3    | 175362 o  |
| 610  | 10   | 3    | 175363 o  |
| 620  | 10   | 3    | 175364 o  |
| 630  | 10   | 3    | 175365    |
| 635  | 10   | 3    | 175366 o  |
| 637  | 10   | 3    | 175367 o  |
| [mm] | [mm] | [mm] |           |

## Turnover Knives

| B    | H    | S    | Ident-No. |
|------|------|------|-----------|
| 640  | 10   | 3    | 175368    |
| 650  | 10   | 3    | 175369 o  |
| [mm] | [mm] | [mm] |           |

132751

### Turnover Knives HW with 2 cutting edges

Product



Drawing

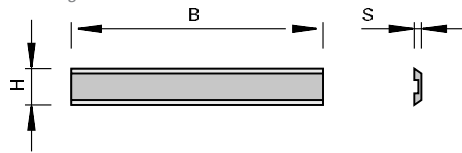

LEUCO  
DUR

Tungsten Carbide [HW]

Machine / Application

l for use in Terna planing  
cutterheads

Design

l cutting material: HW tungsten  
carbide

Advantages

Notes

| B    | H    | S    | Ident-No. |
|------|------|------|-----------|
| 60   | 10   | 3    | 175205 o  |
| 70   | 10   | 3    | 175206 o  |
| 80   | 10   | 3    | 175207 o  |
| 90   | 10   | 3    | 175208 o  |
| 100  | 10   | 3    | 175209 o  |
| 110  | 10   | 3    | 175210 o  |
| 120  | 10   | 3    | 175211 o  |
| 130  | 10   | 3    | 175212 o  |
| 140  | 10   | 3    | 175213 o  |
| 150  | 10   | 3    | 175214 o  |
| 160  | 10   | 3    | 175215 o  |
| 170  | 10   | 3    | 175216 o  |
| 180  | 10   | 3    | 175217 o  |
| 185  | 10   | 3    | 175218 o  |
| 190  | 10   | 3    | 175219 o  |
| 200  | 10   | 3    | 175220 o  |
| 210  | 10   | 3    | 175221 o  |
| 220  | 10   | 3    | 175222 o  |
| 230  | 10   | 3    | 175223    |
| 240  | 10   | 3    | 175224 o  |
| 250  | 10   | 3    | 175225 o  |
| 260  | 10   | 3    | 175226 o  |
| 265  | 10   | 3    | 175227 o  |
| 270  | 10   | 3    | 175228 o  |
| 280  | 10   | 3    | 175229 o  |
| 290  | 10   | 3    | 175230 o  |
| 300  | 10   | 3    | 175231 o  |
| 310  | 10   | 3    | 175232 o  |
| 315  | 10   | 3    | 175233 o  |
| 320  | 10   | 3    | 175234 o  |
| 330  | 10   | 3    | 175235 o  |
| 340  | 10   | 3    | 175236 o  |
| 350  | 10   | 3    | 175237 o  |
| 360  | 10   | 3    | 175238 o  |
| 370  | 10   | 3    | 175239 o  |
| 380  | 10   | 3    | 175240 o  |
| 390  | 10   | 3    | 175241 o  |
| 400  | 10   | 3    | 175242    |
| [mm] | [mm] | [mm] |           |

| B    | H    | S    | Ident-No. |
|------|------|------|-----------|
| 410  | 10   | 3    | 175243 o  |
| 420  | 10   | 3    | 175244 o  |
| 430  | 10   | 3    | 175245 o  |
| 440  | 10   | 3    | 175246 o  |
| 450  | 10   | 3    | 175247 o  |
| 460  | 10   | 3    | 175248 o  |
| 470  | 10   | 3    | 175249 o  |
| 480  | 10   | 3    | 175250 o  |
| 490  | 10   | 3    | 175251 o  |
| 500  | 10   | 3    | 175252 o  |
| 510  | 10   | 3    | 175253    |
| 520  | 10   | 3    | 175254 o  |
| 530  | 10   | 3    | 175255 o  |
| 540  | 10   | 3    | 175256 o  |
| 550  | 10   | 3    | 175257 o  |
| 560  | 10   | 3    | 175258 o  |
| 570  | 10   | 3    | 175259 o  |
| 580  | 10   | 3    | 175260 o  |
| 590  | 10   | 3    | 175261 o  |
| 600  | 10   | 3    | 175262 o  |
| 610  | 10   | 3    | 175263 o  |
| 620  | 10   | 3    | 175264 o  |
| 630  | 10   | 3    | 175265 o  |
| 635  | 10   | 3    | 175266 o  |
| 640  | 10   | 3    | 175268 o  |
| 650  | 10   | 3    | 175269 o  |
| [mm] | [mm] | [mm] |           |

165512

## Centering Points

Product

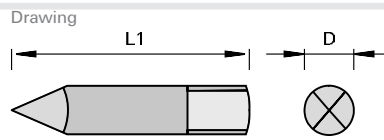

LEUCO  
DUR

Tungsten Carbide [HW]

Machine / Application

Design

Advantages

Notes

| with surface on shank for set screw  
| cutting material: HW  
| HL Solid 40 for hard and soft woods

| packing unit: 10 pieces

| Ø D  | L1   | Ident-No. |
|------|------|-----------|
| 3    | 33.5 | 162624    |
| [mm] | [mm] |           |

150535

### Mini Turnover Knives with 2 cutting edges

Product



Drawing

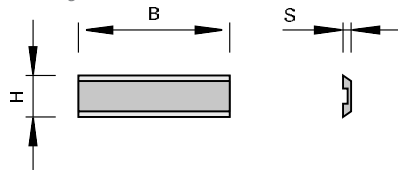

Tungsten Carbide [HW]

Machine / Application

for use in shank-type cutter-heads

Design

cutting material: HW  
HL Board 05 for wood-based panels, plastics and hard woods

Advantages

Notes

packing unit: 10 pieces

| B    | H    | S    | Ident-No. |
|------|------|------|-----------|
| 12   | 5.5  | 1.1  | 162670    |
| 20   | 5.5  | 1.1  | 160623    |
| 40   | 5.5  | 1.1  | 160674    |
| 50   | 5.5  | 1.1  | 163572    |
| [mm] | [mm] | [mm] |           |

150535

### Mini Turnover Knives with 2 cutting edges, end sharpened

Product



Drawing

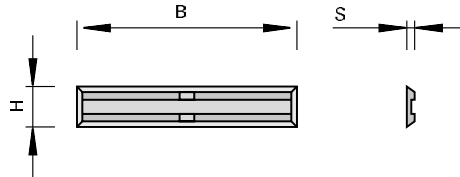

Tungsten Carbide [HW]

Machine / Application

for use in shank-type cutters

Design

cutting material: HW  
HL Board 05 for wood-based panels, plastics and hard woods

Advantages

Notes

packing unit: 10 pieces

| B    | H    | S    | Ident-No. |
|------|------|------|-----------|
| 12   | 5.5  | 1.1  | 168696    |
| 20   | 4.1  | 1.1  | 173480    |
| 20   | 5.5  | 1.1  | 173481    |
| 25   | 5.5  | 1.1  | 173793    |
| 30   | 5.5  | 1.1  | 173482    |
| 50   | 5.5  | 1.1  | 173483    |
| [mm] | [mm] | [mm] |           |

150535

## Mini Turnover Knives with 2 cutting edges, end bevel

Product

Drawing

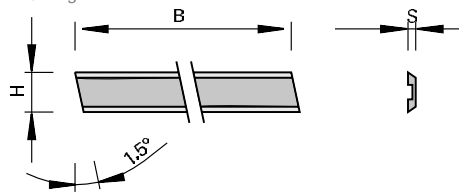

LEUCO  
DUR

Tungsten Carbide [HW]

Machine / Application

| CNC machining centers  
| for use in shank-type cutters

Design

| cutting material: HW  
| HL Board 05 for wood-based panels, plastics and hard woods

Advantages

Notes

| packing unit: 10 pieces

| B    | H    | S    | Ident-No. |
|------|------|------|-----------|
| 39,8 | 5.5  | 1.1  | 163211 o  |
| [mm] | [mm] | [mm] |           |

150549

## Portable Planer Turnover Knives with 2 cutting edges and edge bevel

Product



Drawing

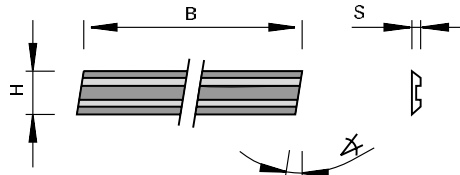

Tungsten Carbide [HW]

Machine / Application

| portable planers

Design

| cutting material: HW  
| HL Solid 40 for hard and soft woods

Advantages

Notes

| Ident-No. 166381 can only be used in the original ELU clamping element  
| Ident-No. 166080 can only be used in the original Black+Decker clamping element  
| packing unit: 10 pieces

| B    | H    | S    | Freiwinkel | Ident-No.   |
|------|------|------|------------|---|
| 75,5 | 5.5  | 1.1  | 1.5        | AEG HTH 75, Bosch 0590, P400, 1590, 1591, Festo REP 75, Haffner FH 222, HOLZ-HER 2223, 2286, 2320, Kress Jet Star 6701, Mafell HU 75, Metabo 6375, Scheer MH 80, MH 75/3, Skil 98 H<br>162439 |
| 75,7 | 5.5  | 1.2  | 8          | Black&Decker DN 750<br>166079 o   |
| 80,5 | 5.9  | 1.2  | 8          | ELU MFF 80<br>166381  |
| 82   | 5.5  | 1.1  | 3          | AEG, Fein, Haffner, Hitachi, Mafell, Makita, Metabo, Bosch<br>165617  |
| 102  | 5.5  | 1.1  | 3          | AEG EH 102, HB 750<br>419671 o  |
| [mm] | [mm] | [mm] | [°]        |   |

151545

### Radius Profile Knives with 2 cutting radii

Product



Drawing

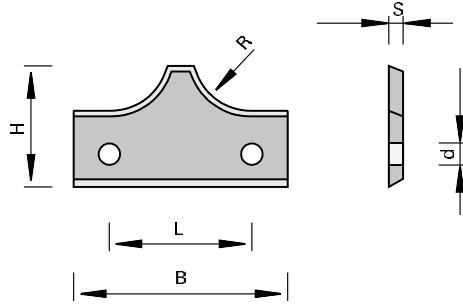

LEUCO  
DUR

Tungsten Carbide [HW]

Machine / Application

l for use in edge rounding  
cutterheads

Design

l cutting material: HW  
l HL Board 05 for wood-based  
panels, plastics and hard  
woods

Advantages

Notes

l packing unit: 10 pieces

| R    | B    | H    | S    | Ø d  | L    |       | Ident-No. |
|------|------|------|------|------|------|-------|-----------|
| 2    | 20,5 | 15   | 2    | 3    | 12   | Homag | 163062    |
| 3    | 20,8 | 15   | 2    | 3    | 12   | Homag | 163063    |
| 5    | 30   | 17   | 2    | 3    | 20   | Homag | 163065    |
| 4    | 20,8 | 15   | 2    | 3    | 12   | Homag | 163064 s  |
| 6    | 30,5 | 17   | 2    | 3    | 20   | Homag | 163066    |
| 7    | 30   | 17   | 2    | 3    | 20   | Homag | 163067    |
| 8    | 30,5 | 17   | 2    | 3    | 20   | Homag | 163068    |
| 2    | 20,8 | 14,7 | 2    | 3    | 12   | IMA   | 164166 s  |
| 3    | 20,8 | 14,7 | 2    | 3    | 12   | IMA   | 164167 s  |
| 4    | 20,8 | 14,7 | 2    | 3    | 12   | IMA   | 164168 s  |
| 5    | 30,5 | 16,5 | 2    | 3    | 20   | IMA   | 164169 s  |
| 6    | 30,5 | 16,5 | 2    | 3    | 20   | IMA   | 164170 s  |
| 7    | 30,5 | 16,5 | 2    | 3    | 20   | IMA   | 164171 s  |
| 8    | 30,5 | 16,5 | 2    | 3    | 20   | IMA   | 164172 s  |
| [mm] | [mm] | [mm] | [mm] | [mm] | [mm] |       |           |

151545 / 151585

### Radius Profile Knives with 2 cutting radii and bottom chamfer

Product



Drawing

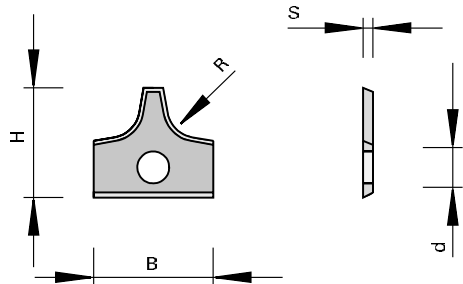

LEUCO  
DUR

Tungsten Carbide [HW]

Machine / Application

l for use in edge rounding  
cutterheads

Design

l cutting material: HW  
l HL Board 05 for wood-based  
panels, plastics and hard  
woods

Advantages

Notes

l packing unit: 10 pieces

| R    | B    | H    | S    | Ø d  |  | Ident-No. |
|------|------|------|------|------|--|-----------|
| 1,5  | 16   | 17,5 | 2    | 4,4  |  | 176583    |
| 2    | 12   | 12   | 1,5  | 4    |  | 170340    |
| 2    | 16   | 15,5 | 2    | 4    |  | 182087    |
| 2    | 16   | 17,5 | 2    | 4,4  |  | 163489    |
| 2,5  | 16   | 17,5 | 2    | 4,4  |  | 171178    |
| [mm] | [mm] | [mm] | [mm] | [mm] |  |           |



| R    | B    | H    | S    | Ø d  | Ident-No. |
|------|------|------|------|------|-----------|
| 3    | 12   | 12   | 1.5  | 4    | 170341    |
| 3    | 16   | 17.5 | 2    | 4,4  | 163490    |
| 4    | 16   | 17.5 | 2    | 4,4  | 163491    |
| 5    | 16   | 17.5 | 2    | 4,4  | 163492    |
| [mm] | [mm] | [mm] | [mm] | [mm] |           |

151545 / 151585

### Radius Profile Knives with 2 cutting radii

|  |  |   |
|--|--|---|
| <p>Product</p>   | <p>Drawing</p>   | <p>Tungsten Carbide [HW]</p>                                  |
| <p>Machine / Application</p> <p>for use in edge rounding cutterheads</p> | <p>Design</p> <p>cutting material: HW<br/>HL Board O5 for wood-based panels, plastics and hard woods</p> | <p>Advantages</p> <p>Notes</p> <p>packing unit: 10 pieces</p> |

| R    | B    | H    | S    | Ø d  | Ident-No. |
|------|------|------|------|------|-----------|
| 2    | 12   | 13   | 2    | 5    | 177033    |
| 2,5  | 12   | 13   | 2    | 4    | 173707    |
| 3    | 12   | 13   | 2    | 5    | 177032    |
| 6    | 24   | 22   | 2    | 4,4  | 170258    |
| 8    | 24   | 22   | 2    | 4,4  | 170260    |
| 9    | 24   | 22   | 2    | 4,4  | 170261    |
| [mm] | [mm] | [mm] | [mm] | [mm] |           |

151545 / 151585

### Radius Profile Knives with 2 cutting radii and bottom chamfer - IMA, Wilmsmayer, Torwegge

|   |  |   |
|---|--|---|
| <p>Product</p>  | <p>Drawing</p>   | <p>Tungsten Carbide [HW]</p>                                  |
| <p>Machine / Application</p> <p>machines IMA, Wilmsmayer, Torwegge<br/>for use in scraper holders</p> | <p>Design</p> <p>cutting material: HW<br/>HL Board O5 for wood-based panels, plastics and hard woods</p> | <p>Advantages</p> <p>Notes</p> <p>packing unit: 10 pieces</p> |

| R    | B    | H    | S    | Ø d  | Ident-No. |
|------|------|------|------|------|-----------|
| 2    | 16   | 17.5 | 2    | 3    | 173475    |
| 2,5  | 16   | 17.5 | 2    | 3    | 173476 s  |
| 3    | 16   | 17.5 | 2    | 3    | 173477    |
| 4    | 16   | 17.5 | 2    | 3    | 173478    |
| 5    | 16   | 17.5 | 2    | 3    | 173479    |
| [mm] | [mm] | [mm] | [mm] | [mm] |           |

151545 / 151585

### Radius Profile Knives with 2 cutting radii and bottom chamfer - Brandt

Product

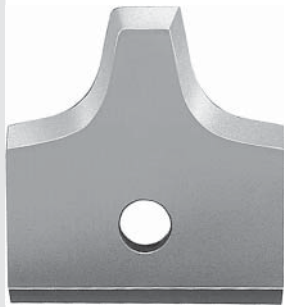

Drawing

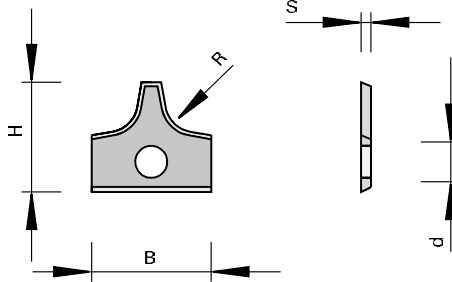

Tungsten Carbide [HW]

Machine / Application

| copying-unit Brandt  
| for use in edge rounding  
cutterheads

Design

| cutting material: HW  
| HL Board O5 for wood-based  
panels, plastics and hard  
woods

Advantages

Notes

| packing unit: 10 pieces

| R    | B    | H    | S    | Ø d  | Ident-No. |
|------|------|------|------|------|-----------|
| 2    | 16   | 17.5 | 2    | 4,4  | 180153    |
| 3    | 16   | 17.5 | 2    | 4,4  | 180154    |
| [mm] | [mm] | [mm] | [mm] | [mm] |           |

151555

### Radius Profile Knives with 2 cutting radii

Product

Drawing

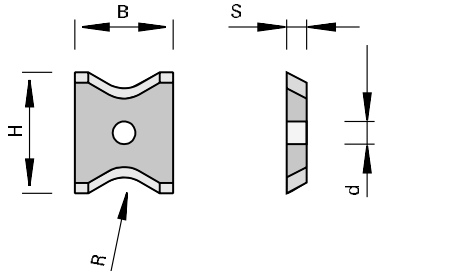

Tungsten Carbide [HW]

Machine / Application

| for use in edge banding /  
rounding cutterheads

Design

| cutting material: HW  
| HL Board O5 for wood-based  
panels, plastics and hard  
woods  
| 5 degree profile run-out

Advantages

Notes

| packing unit: 10 pieces

| R    | B    | H    | S    | Ø d  | Ident-No. |
|------|------|------|------|------|-----------|
| 2    | 13   | 16   | 2    | 4    | 162794    |
| 3    | 13   | 16   | 2    | 4    | 162795    |
| 4    | 13   | 16   | 2    | 4    | 162565    |
| [mm] | [mm] | [mm] | [mm] | [mm] |           |

151555

### Radius Profile Knives with 2 cutting radii - IMA

Product

Drawing

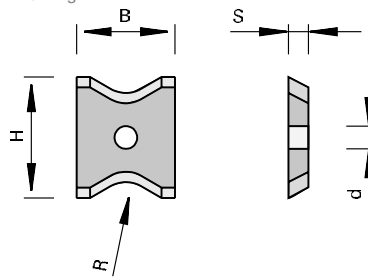

Tungsten Carbide [HW]

Machine / Application

l machines IMA  
l for use in edge banding / rounding cutterheads

Design

l 15 degree profile run-out  
l cutting material: HW  
l HL Board 05 for wood-based panels, plastics and hard woods

Advantages

Notes

l packing unit: 10 pieces

| R    | B    | H    | S    | Ø d  | Ident-No. |
|------|------|------|------|------|-----------|
| 2    | 13   | 16   | 2    | 4    | 172713    |
| 3    | 13   | 16   | 2    | 4    | 172714    |
| 4    | 13   | 16   | 2    | 4    | 172715    |
| [mm] | [mm] | [mm] | [mm] | [mm] |           |

151555

### Radius Profile Knives with 2 cutting radii

Product

Drawing

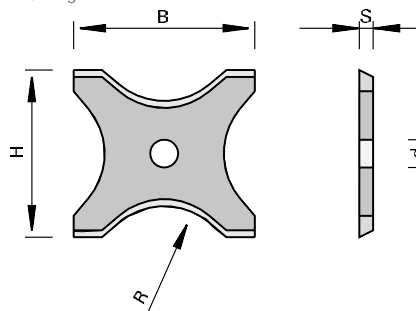
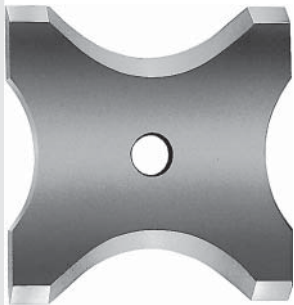

Tungsten Carbide [HW]

Machine / Application

l for use in edge banding / rounding cutterheads

Design

l 5 degree profile run-out  
l cutting material: HW  
l HL Board 05 for wood-based panels, plastics and hard woods

Advantages

Notes

l packing unit: 10 pieces

| R    | B    | H    | S    | Ø d  | Ident-No. |
|------|------|------|------|------|-----------|
| 5    | 20   | 21   | 2    | 4    | 162566    |
| 6    | 20   | 21   | 2    | 4    | 162567    |
| 7    | 20   | 21   | 2    | 4    | 162568    |
| 8    | 20   | 21   | 2    | 4    | 162569    |
| 9    | 26   | 24   | 2    | 4    | 162796    |
| 10   | 26   | 24   | 2    | 4    | 162570    |
| 11   | 26   | 24   | 2    | 4    | 162571    |
| 12   | 26   | 24   | 2    | 4    | 162572    |
| [mm] | [mm] | [mm] | [mm] | [mm] |           |

151555

### Radius Turnover Knives with 2 cutting radii

Product

Drawing

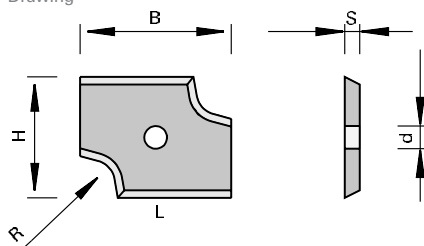

Tungsten Carbide [HW]

Machine / Application

for use in edge rounding cutterheads

Design

cutting material: HW  
HL Board 05 for wood-based panels, plastics and hard woods

Advantages

Notes

packing unit: 10 pieces

| R    | B    | H    | S    | Ø d  |       | Ident-No. [L] | Ident-No. [R] |
|------|------|------|------|------|-------|---------------|---------------|
| 3    | 20   | 16   | 2    | 3    |       | 168355        | 168356        |
| 2    | 30   | 14   | 2    | 4    | Reich | 177136        | 177135        |
| 2,5  | 30   | 14   | 2    | 4    | Reich | 177138        | 177137        |
| 3    | 30   | 14   | 2    | 4    | Reich | 177140        | 177139        |
| [mm] | [mm] | [mm] | [mm] | [mm] |       |               |               |

151545

### Radius Profile Knives with 1 cutting radius

Product

Drawing

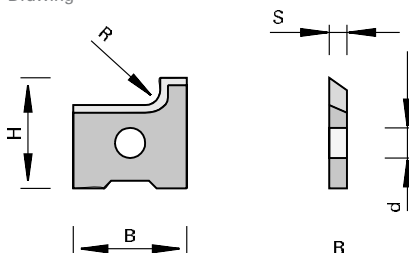

Tungsten Carbide [HW]

Machine / Application

for use in edge rounding cutterheads

Design

cutting material: HW  
HL Board 05 for wood-based panels, plastics and hard woods

Advantages

Notes

packing unit: 10 pieces

| R    | B    | H    | S    | Ø d  |  | Ident-No. [L] | Ident-No. [R] |
|------|------|------|------|------|--|---------------|---------------|
| 2    | 12   | 18   | 2    | 4    |  |               | 172725        |
| 2    | 15   | 14.5 | 2    | 4    |  | 177317        | 177318        |
| 2    | 16,1 | 14   | 2    | 4    |  | 178219        | 178218        |
| 2    | 19,6 | 15.2 | 2    | 4    |  | 173817        | 173816        |
| 2,5  | 15   | 14.5 | 2    | 4    |  | 177319        | 177320        |
| 3    | 12   | 18   | 2    | 4    |  |               | 172726        |
| 3    | 15   | 14.5 | 2    | 4    |  | 177321        | 177322        |
| 3    | 16,1 | 14   | 2    | 4    |  | 178221        | 178220        |
| 3    | 19,6 | 15.2 | 2    | 4    |  | 173393        | 173392        |
| [mm] | [mm] | [mm] | [mm] | [mm] |  |               |               |

151545

### Radius Profile Knives with 1 cutting radius

Product

Drawing

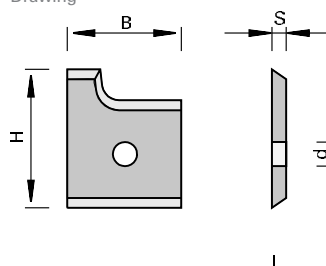

Tungsten Carbide [HW]

Machine / Application

for use in edge rounding cutterheads

Design

cutting material: HW  
HL Board 05 for wood-based panels, plastics and hard woods

Advantages

Notes

packing unit: 10 pieces

| R    | B    | H    | S    | Ø d  | Ident-No. [L] | Ident-No. [R] |
|------|------|------|------|------|---------------|---------------|
| 2    | 12   | 14.5 | 2    | 4    | 172142        | 172141        |
| 2,5  | 12   | 14.5 | 2    | 4    | 171224        | 171223        |
| 3    | 12   | 14.5 | 2    | 4    | 172144        | 172143        |
| [mm] | [mm] | [mm] | [mm] | [mm] |               |               |

151545

### Radius Profile Knives with 1 cutting radius

Product

Drawing

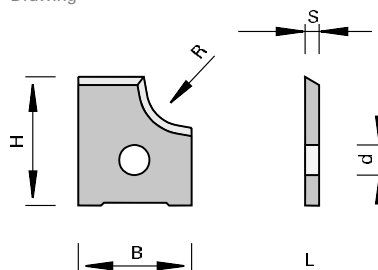

Tungsten Carbide [HW]

Machine / Application

for use in rounding cutterheads

Design

5 degree profile run-out  
cutting material: HW  
HL Board 05 for wood-based panels, plastics and hard woods

Advantages

Notes

packing unit: 10 pieces

Notes for sales staff

s = price as per special price calculation

| R    | B    | H    | S    | Ø d  | Ident-No. [L] | Ident-No. [R] |
|------|------|------|------|------|---------------|---------------|
| 3    | 15   | 18.4 | 2    | 4    | 168272        | 168279        |
| 4    | 15   | 18.4 | 2    | 4    | 168273        | 168280        |
| 5    | 15   | 18.4 | 2    | 4    | 168274        | 168281        |
| 6    | 15   | 21.6 | 2    | 4    | 168286        | 168293        |
| 8    | 15   | 21.6 | 2    | 4    | 168288        | 168295        |
| 9    | 20   | 25.8 | 2    | 4    | 168301 #      | 168310 #      |
| 10   | 20   | 25.8 | 2    | 4    | 168302 s      | 168311 s      |
| 12   | 20   | 25.8 | 2    | 4    | 168304 s      | 168313        |
| [mm] | [mm] | [mm] | [mm] | [mm] |               |               |

151545

### Radius Profile Knives with 1 cutting radius

Product

Drawing

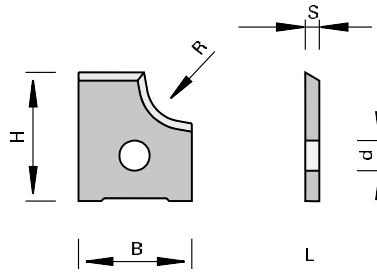

Tungsten Carbide [HW]

Machine / Application

Design

Advantages

Notes

- | 10 degree profile run-out
- | cutting material: HW
- | HL Board 05 for wood-based panels, plastics and hard woods
- | HL Board 06 for wood-based panels, plastics and soft woods

| packing unit: 10 pieces

| R    | B    | H    | S    | Ø d  | LEUCODUR    | Ident-No. [L] | Ident-No. [R] |
|------|------|------|------|------|-------------|---------------|---------------|
| 1,5  | 13   | 15   | 2    | 4    | HL Board 06 | 181954        | 181953        |
| 2    | 12   | 15   | 2    | 4    | HL Board 06 | 177034        | 177038        |
| 2    | 13   | 15   | 2    | 4    | HL Board 06 | 181956        | 181955        |
| 3    | 13   | 15   | 2    | 4    | HL Board 06 | 181957        | 181958        |
| 4    | 14   | 17   | 2    | 4    | HL Board 05 | 177036        | 177040        |
| 5    | 15   | 17   | 2    | 4    | HL Board 05 | 177037        | 177041        |
| [mm] | [mm] | [mm] | [mm] | [mm] |             |               |               |

151545

### Radius Profile Knives with 1 cutting radius - Homag

Product

Drawing

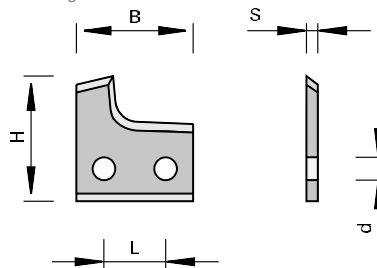

Tungsten Carbide [HW]

Machine / Application

Design

Advantages

Notes

- | machines Homag
- | for use in rounding cutterheads

- | 5 degree profile run-out
- | cutting material: HW
- | HL Board 05 for wood-based panels, plastics and hard woods

| R    | B    | H    | S    | Ø d  | L    | Ident-No. [L] | Ident-No. [R] |
|------|------|------|------|------|------|---------------|---------------|
| 10   | 21,8 | 20   | 2    | 3    | 12   | 163071        | 163072        |
| 12   | 21,8 | 20   | 2    | 3    | 12   | 163075        | 163076        |
| [mm] | [mm] | [mm] | [mm] | [mm] | [mm] |               |               |

151545

### Radius Profile Knives with 1 cutting radius - IMA

Product



Drawing

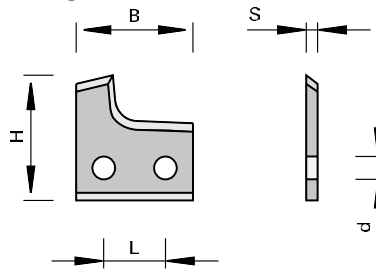

Tungsten Carbide [HW]

Machine / Application

| for use in rounding cutterheads

Design

| 5 degree profile run-out  
| cutting material: HW  
| HL Board 05 for wood-based panels, plastics and hard woods

Advantages

Notes

| packing unit: 10 pieces

| R    | B    | H    | S    | Ø d  | L    | Ident-No. [L] | Ident-No. [R] |
|------|------|------|------|------|------|---------------|---------------|
| 9    | 21,8 | 19,5 | 2    | 3    | 12   | 164173 s      | 164174 s      |
| 10   | 21,8 | 19,5 | 2    | 3    | 12   | 164175 s      | 164176 s      |
| 11   | 21,8 | 19,5 | 2    | 3    | 12   | 164177 s      | 164178 s      |
| 12   | 21,8 | 19,5 | 2    | 3    | 12   | 164179 s      | 164180 s      |
| [mm] | [mm] | [mm] | [mm] | [mm] | [mm] |               |               |

151545

### Radius Profile Knives with 1 cutting radius - IMA

Product



Drawing

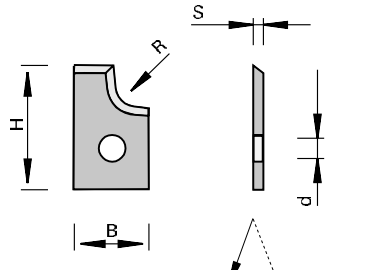

Tungsten Carbide [HW]

Machine / Application

| machines IMA  
| for use in rounding cutterheads

Design

| 15 degree profile run-out  
| cutting material: HW  
| HL Board 05 for wood-based panels, plastics and hard woods

Advantages

Notes

| packing unit: 10 pieces

| R    | B    | H    | S    | Ø d  | Ident-No. [L] | Ident-No. [R] |
|------|------|------|------|------|---------------|---------------|
| 2    | 12   | 18   | 2    | 5    | 180174        | 180173        |
| 3    | 12   | 18   | 2    | 5    | 180176        | 180175        |
| [mm] | [mm] | [mm] | [mm] | [mm] |               |               |

151545

### Chamfering Profile Knives with 2 cutting edges

Product

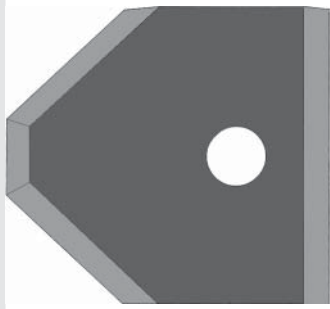

Drawing

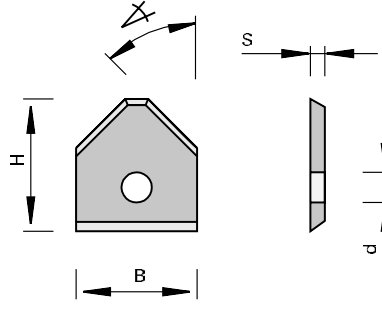

Tungsten Carbide [HW]

Machine / Application

| for use in edge rounding  
cutterheads

Design

| cutting material: HW  
| HL Board 05 for wood-based  
panels, plastics and hard  
woods

Advantages

Notes

| Ident-No. 180792 for Modula  
| packing unit: 10 pieces

| chamfer $\sphericalangle$ | B    | H    | S    | $\varnothing$ d | Ident-No. |
|---------------------------|------|------|------|-----------------|-----------|
| 45                        | 12   | 12   | 1.5  | 4               | 180792    |
| 45                        | 12   | 12   | 1.5  | 4               | 171190    |
| 45                        | 16   | 17.5 | 2    | 3               | 169292    |
| 45                        | 16   | 17.5 | 2    | 4,3             | 170329    |
| [°]                       | [mm] | [mm] | [mm] | [mm]            |           |

151545 / 151546

### Chamfering Profile Knives with 1 cutting edge

Product



Drawing

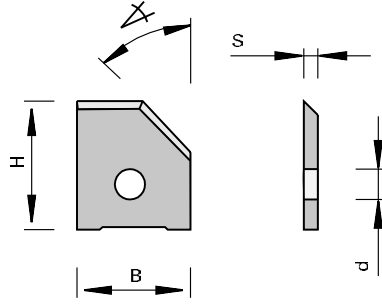

Tungsten Carbide [HW]

Machine / Application

| machining centers Homag  
| for use in chamfering cutter-  
heads

Design

| cutting material: HW  
| HL Board 05 for wood-based  
panels, plastics and hard  
woods  
| HL Board 06 for wood-based  
panels, plastics and soft woods

Advantages

Notes

| packing unit: 10 pieces

| chamfer $\sphericalangle$ | B    | H    | S    | $\varnothing$ d | LEUCODUR    | Ident-No. [L] | Ident-No. [R] |
|---------------------------|------|------|------|-----------------|-------------|---------------|---------------|
| 15                        | 12   | 16   | 2    | 4               | HL Board 05 | 177042        | 177045        |
| 30                        | 13,5 | 16   | 2    | 4               | HL Board 05 | 177043        | 177046        |
| 45                        | 15   | 16   | 2    | 4               | HL Board 05 | 177044 s      | 177047 s      |
| 5                         | 12   | 16   | 2    | 5               | HL Board 06 | 179174        | 179173        |
| 45                        | 12   | 16   | 2    | 4               | HL Board 05 | 177823        | 177822        |
| [°]                       | [mm] | [mm] | [mm] | [mm]            |             |               |               |



151519

### Profile Turnover Knives for alucobond - HOLZ-HER

Product

Drawing

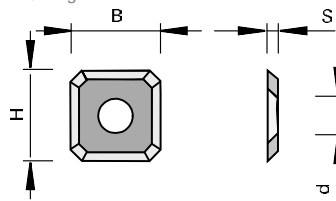

Tungsten Carbide [HW]

Machine / Application

vertical panel sizing saws  
HOLZ-HER  
for use in 90 degree Folding  
cutterhead Ident-No. 879632  
for the machining of alucubond

Design

cutting material: HW  
HL Solid 40 for hard and soft  
woods

Advantages

Notes

packing unit: 10 pieces

| B    | H    | S    | Ø d  | ∠   | Ident-No. |
|------|------|------|------|-----|-----------|
| 14   | 14   | 2    | 6,3  | 90  | 182079    |
| [mm] | [mm] | [mm] | [mm] | [°] |           |

151516

### Profile Turnover Knives

Product

Drawing

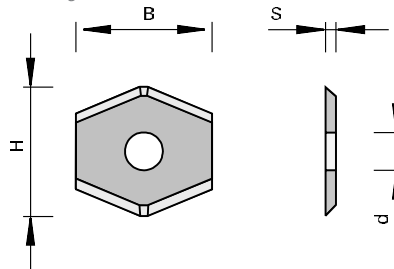

Tungsten Carbide [HW]

Machine / Application

vertical panel sizing saws  
HOLZ-HER  
for use in 135 degree Folding  
cutterhead Ident-No. 703144  
for the machining of alucubond

Design

cutting material: HW  
HL Board 06 for wood-based  
panels, plastics and soft woods

Advantages

Notes

packing unit: 10 pieces

| B    | H    | S    | Ø d  | ∠   | Ident-No. |
|------|------|------|------|-----|-----------|
| 20   | 18   | 2    | 5,7  | 135 | 182080 s  |
| [mm] | [mm] | [mm] | [mm] | [°] |           |

151586

## Profile Knives - Brandt

Product

Drawing

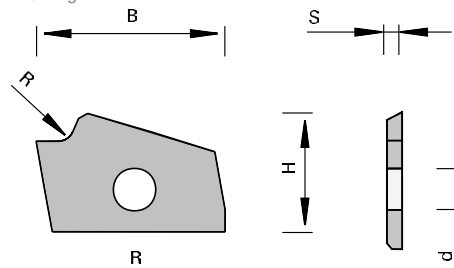

Tungsten Carbide [HW]

Machine / Application

edge banding machines Brandt since date of fabrication 2005 for use in rounding cutterheads with special chip removing design

Design

cutting material: HW HL Board 06 for wood-based panels, plastics and soft woods

Advantages

Notes

packing unit: 10 pieces

| R    | B     | H    | S    | Ø d  | Ident-No. [L] | Ident-No. [R] |
|------|-------|------|------|------|---------------|---------------|
| 2    | 22,32 | 14   | 2    | 5    | 182331        | 182332        |
| 2,5  | 22,32 | 14   | 2    | 5    | 182367        | 182368        |
| 3    | 22,32 | 14   | 2    | 5    | 182333        | 182334        |
| [mm] | [mm]  | [mm] | [mm] | [mm] |               |               |

151.586

## Profile Knives - Brandt

Product

Drawing

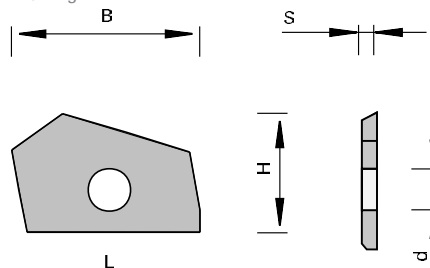

Tungsten Carbide [HW]

Machine / Application

edge banding machines Brandt since date of fabrication 2005 for use in rounding cutterheads with special chip removing design

Design

cutting material: HW HL Board 06 for wood-based panels, plastics and soft woods

Advantages

Notes

packing unit: 10 pieces

| chamfer∠ | B     | H    | S    | Ø d  | Ident-No. [L] | Ident-No. [R] |
|----------|-------|------|------|------|---------------|---------------|
| 45       | 22,32 | 14   | 2    | 5    | 182667        | 182666        |
| [°]      | [mm]  | [mm] | [mm] | [mm] |               |               |

150515 / 151545

### Modula Knives

Product

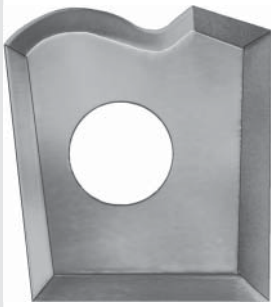

Drawing

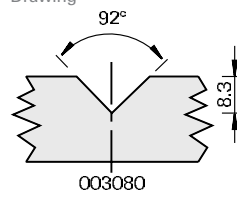

Tungsten Carbide [HW]

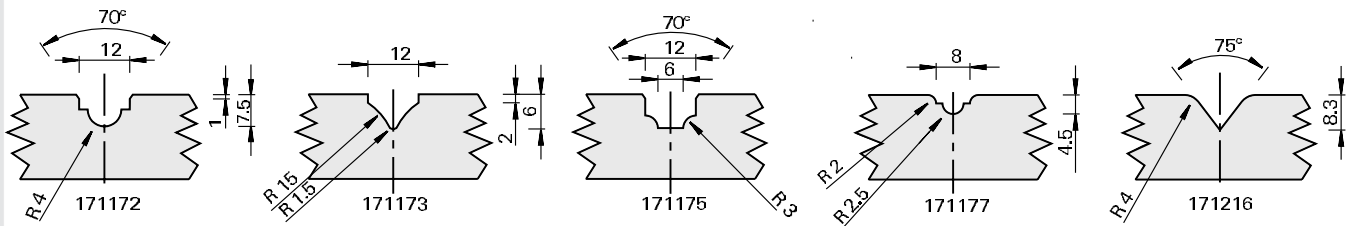

Machine / Application

for use in ornamental groove cutterheads

Design

cutting material: HW  
HL Board 05 for wood-based panels, plastics and hard woods

Advantages

Notes

packing unit: 10 pieces

| B    | H    | S    | Ø d  | Ident-No. |
|------|------|------|------|-----------|
| 12   | 12   | 1.5  | 4    | 003080    |
| 12   | 12   | 1.5  | 4    | 171177    |
| 11   | 12   | 1.5  | 4    | 171175    |
| 11   | 12   | 1.5  | 4    | 171172    |
| 12   | 12   | 1.5  | 4    | 171216    |
| 11   | 12   | 1.5  | 4    | 171173    |
| [mm] | [mm] | [mm] | [mm] |           |

151548

### Profile Knives

Product

Drawing

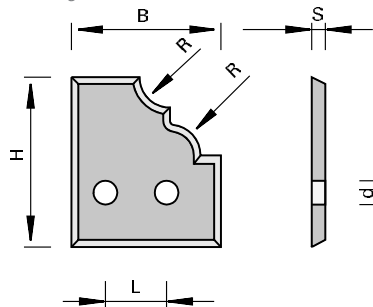

Tungsten Carbide [HW]

Machine / Application

for use in stile-and-rail profile cutterheads

Design

cutting material: HW  
HL Solid 25 for hard and soft woods

Advantages

Notes

packing unit: 10 pieces

| R    | B    | H    | S    | Ø d  | L    | Ident-No. |
|------|------|------|------|------|------|-----------|
| 4,5  | 16,3 | 24,5 | 2    | 3,5  | 8,3  | 166126 #  |
| 4,5  | 19,3 | 24,5 | 2    | 3,5  | 11,2 | 165912    |
| 6,5  | 16,3 | 24,5 | 2    | 3,5  | 8,3  | 166127    |
| [mm] | [mm] | [mm] | [mm] | [mm] | [mm] |           |

151548

## Profile Knives

Product

Drawing

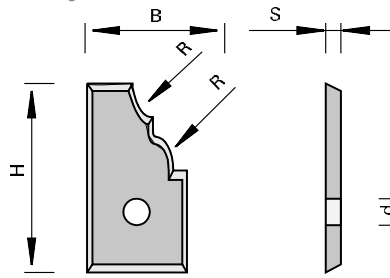

LEUCO  
DUR

Tungsten Carbide [HW]

Machine / Application

I for use in stile-and-rail profile cutterheads

Design

I cutting material: HW  
I HL Solid 25 for hard and soft woods

Advantages

Notes

| R    | B    | H    | S    | Ø d  | L    | Ident-No. |
|------|------|------|------|------|------|-----------|
| 7    | 13,3 | 24.5 | 2    | 3,5  |      | 167469    |
| [mm] | [mm] | [mm] | [mm] | [mm] | [mm] |           |

151548

## Profile Knives

Product

Drawing

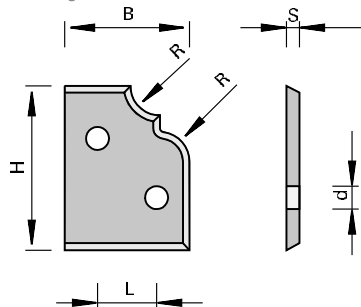

LEUCO  
DUR

Tungsten Carbide [HW]

Machine / Application

I for use in panel-raising cutterheads

Design

I cutting material: HW  
I HL Solid 25 for hard and soft woods

Advantages

Notes

I packing unit: 10 pieces

| R    | B    | H    | S    | Ø d  | L    | Ident-No. |
|------|------|------|------|------|------|-----------|
| 4,5  | 19   | 25   | 2    | 3,5  | 9    | 165930    |
| [mm] | [mm] | [mm] | [mm] | [mm] | [mm] |           |

151548

## Profile Knives

Product

Drawing

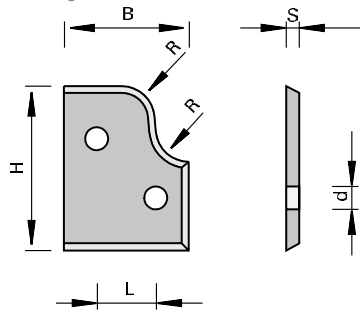

Tungsten Carbide [HW]

Machine / Application

I for use in panel-raising  
cutterheads

Design

I cutting material: HW  
I HL Solid 25 for hard and soft  
woods

Advantages

Notes

I packing unit: 10 pieces

| R    | B    | H    | S    | Ø d  | L    | Ident-No. |
|------|------|------|------|------|------|-----------|
| 5    | 19   | 25   | 2    | 3,5  | 9    | 165932    |
| [mm] | [mm] | [mm] | [mm] | [mm] | [mm] |           |

151548

## Panel Raising Profile Knives

Product

Drawing

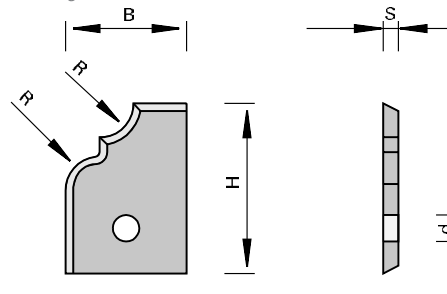
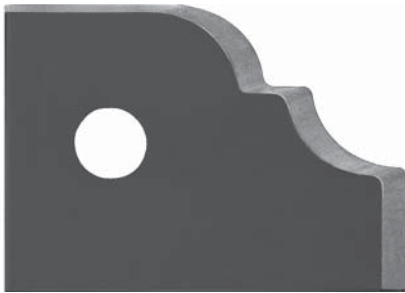

Tungsten Carbide [HW]

Machine / Application

I for use in shank-type panel  
raising cutterheads

Design

I cutting material: HW  
I HL Solid 25 for hard and soft  
woods

Advantages

Notes

I packing unit: 10 pieces

| R    | B    | H    | S    | Ø d  | Ident-No. |
|------|------|------|------|------|-----------|
| 4,5  | 16   | 22.5 | 2    | 4    | 168883    |
| [mm] | [mm] | [mm] | [mm] | [mm] |           |

151548

### Miter Glue Joint Profile Knives

Product



Drawing

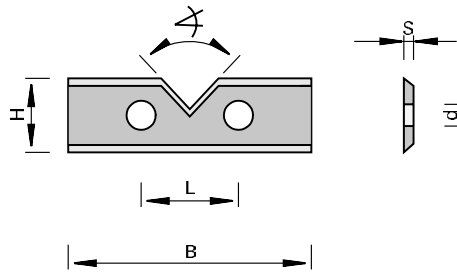

LEUCO  
DUR

Tungsten Carbide [HW]

Notes

| packing unit: 10 pieces

Machine / Application

| for use in miter glue joint cutterheads

Design

| cutting material: HW  
| HL Solid 25 for hard and soft woods

Advantages

| very accurate profiling for optimum glue joints

| chamfer∠ | B    | H    | S    | Ø d  | L    | Ident-No. |
|----------|------|------|------|------|------|-----------|
| 86       | 39,5 | 12   | 1.5  | 4    | 26   | 165916    |
| [°]      | [mm] | [mm] | [mm] | [mm] | [mm] |           |

151558

### Glue Joint Profile Turnover Knives

Product



Drawing

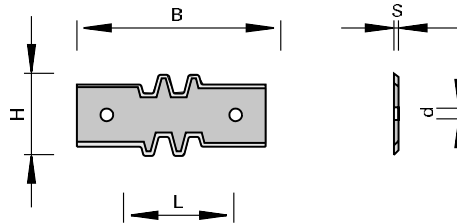

LEUCO  
DUR

Tungsten Carbide [HW]

Notes

| packing unit: 10 pieces

Machine / Application

| for use in glue joint cutterheads

Design

| cutting material: HW  
| HL Solid 25 for hard and soft woods

Advantages

| very accurate profiling for optimum glue joints

| B    | H    | S    | Ø d  | L    | Ident-No. |
|------|------|------|------|------|-----------|
| 50   | 21.6 | 2    | 4    | 26   | 165911    |
| [mm] | [mm] | [mm] | [mm] | [mm] |           |

151558

### Glue Joint Profile Turnover Knives

Product

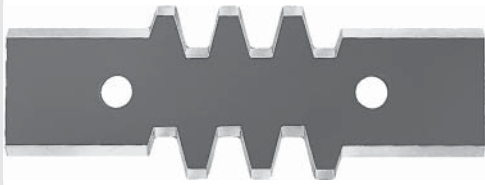

Drawing

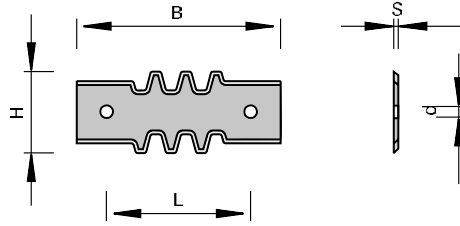

Tungsten Carbide [HW]

Machine / Application

| for use in glue joint cutterheads

Design

| cutting material: HW  
| HL Solid 25 for hard and soft woods

Advantages

| very accurate profiling for optimum glue joints

Notes

| packing unit: 10 pieces

| B          | H            | S         | Ø d       | L          | Ident-No. |
|------------|--------------|-----------|-----------|------------|-----------|
| 60<br>[mm] | 21.6<br>[mm] | 2<br>[mm] | 4<br>[mm] | 32<br>[mm] | 165909    |

151598

### Glue Joint Profile Turnover Knife Set

Product



Drawing

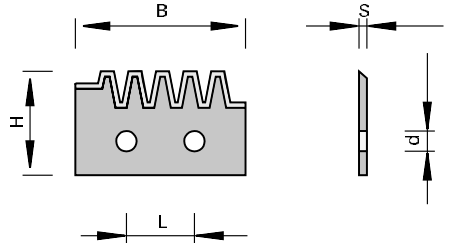

Tungsten Carbide [HW]

Machine / Application

| for use in adjustable glue joint cutterheads

Design

| cutting material: HW  
| HL Solid 25 for hard and soft woods

Advantages

| very accurate profiling for optimum glue joints

Notes

| set consists of 4 pieces  
Ident-No. 167977, 4 pieces  
Ident-No. 167976  
| packing unit: 10 pieces

| B          | H          | S         | Ø d       | L          | Ident-No. |
|------------|------------|-----------|-----------|------------|-----------|
| 42<br>[mm] | 20<br>[mm] | 2<br>[mm] | 4<br>[mm] | 26<br>[mm] | 168240    |

132891

## Turnover Knife Holders - Ledinek Rotoles

Product

Drawing



Tungsten Carbide [HW]

Machine / Application

Design

Advantages

Notes

| planing machines Ledinek Rotoles  
| for LEUCODUR turnover knives straight and with chamfer

| for mounting of LEUCODUR turnover knives 14 x 14 mm and 14.3 x 14.3 mm

|   | Ident-No. |
|---|-----------|
| for thicknesser (TOK 14x14x2) top                   | 182082 o  |
| for service planing rotor (TOK 14x14x2) bottom      | 182083 o  |
| for thicknesser segments (TOK 14,3x14,3x2,5) top    | 182084 o  |
| für Abrichtrotor Segmente (WPL 14,3x14,3x2,5) unten | 182085 o  |

Spare parts

Dimension

Class-No.

Ident-No.

Countersunk Flat Headed Screws

M5x9 T20 D=Ø9,3  
[mm]

995125

827277

150553 / 150555 / 150558 / 150559

## Profile Turnover Knives with 4 cutting edges - Ledinek Rotoles

Product

Drawing

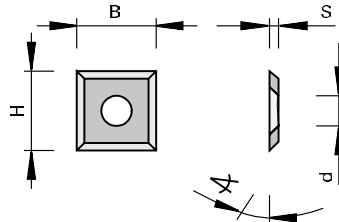

Tungsten Carbide [HW]

Machine / Application

Design

Advantages

Notes

| planing machines Ledinek Rotoles  
| for use in turnover knife holders zum Planfräsen

| cutting material: HW  
| HL Board 03 for wood-based panels and plastics  
| HL Board 05 for wood-based panels, plastics and hard woods  
| HL Solid 15 for wood-based panels, hard and soft woods  
| HL Solid 40 for hard and soft woods

| packing unit: 10 pieces

| B    | H    | S    | LEUCODUR    | Ident-No. |
|------|------|------|-------------|-----------|
| 14   | 14   | 2    | HL Solid 40 | 003079    |
| 14   | 14   | 2    | HL Board 05 | 180954    |
| 14   | 14   | 2    | HL Board 03 | 180646    |
| 14,3 | 14,3 | 2,5  | HL Solid 25 | 170248    |
| [mm] | [mm] | [mm] |             |           |



150558

### Profile Turnover Knives with 4 cutting edges and chamfer - Ledinek Rotoles

Product

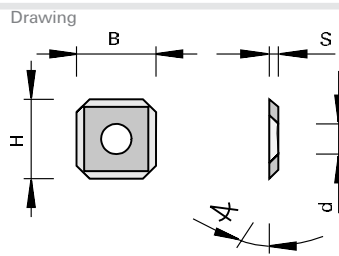

Tungsten Carbide [HW]

Machine / Application

planing machines Ledinek Rotoles  
for use in turnover knife holders zum Planfräsen

Design

cutting material: HW  
HL Solid 15 for wood-based panels, hard and soft woods  
HL Solid 25 for hard and soft woods

Advantages

Notes

packing unit: 10 pieces

| B    | H    | S    | LEUCODUR    | Ident-No. [L] | Ident-No. [R] |
|------|------|------|-------------|---------------|---------------|
| 14   | 14   | 2    | HL Solid 25 | 180933        | 180932        |
| 14,3 | 14,3 | 2,5  | HL Solid 15 | 181144        | 181143        |
| [mm] | [mm] | [mm] |             |               |               |

150558

### Profile Turnover Knives with 4 cutting edges and radius - Ledinek Rotoles

Product

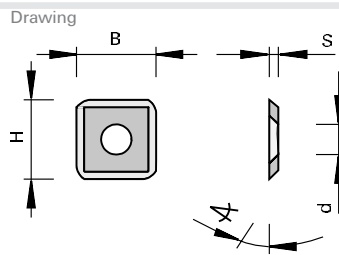

Tungsten Carbide [HW]

Machine / Application

planing machines Ledinek Rotoles  
for use in turnover knife holders zum Planfräsen

Design

cutting material: HW  
HL Solid 15 for wood-based panels, hard and soft woods  
HL Solid 25 for hard and soft woods

Advantages

Notes

packing unit: 10 pieces

| B    | H    | S    | LEUCODUR    | Ident-No. [L] | Ident-No. [R] |
|------|------|------|-------------|---------------|---------------|
| 14   | 14   | 2    | HL Solid 25 | 182442        | 182441        |
| 14,3 | 14,3 | 2,5  | HL Solid 15 | 182444        | 182443        |
| [mm] | [mm] | [mm] |             |               |               |

151527

## SuperProfiler Knives „Multi-Profil“

Product

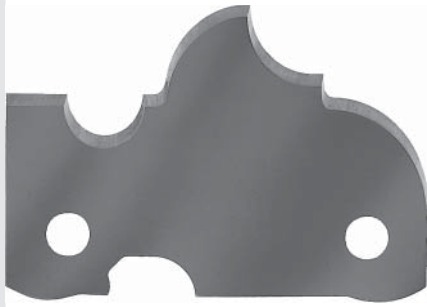

Drawing

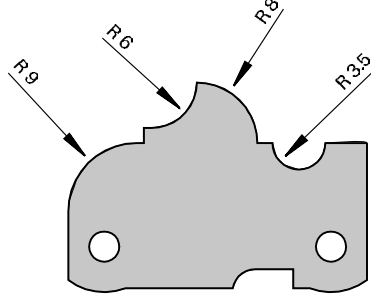

LEUCO  
DUR

Tungsten Carbide [HW]

Machine / Application

| table shapers  
| for use in SuperProfiler  
cutterheads Ident-No. 167897  
and 167894

Design

| cutting material: HW  
| HL Solid 25 for hard and soft  
woods

Advantages

Notes

| for cutting of various profiles  
in one or more steps  
| profile examples see Technical  
Appendix

PU

Ident-No.

12

169273 s

[pc]

## SuperProfiler „Multi-Profile“

1 operation

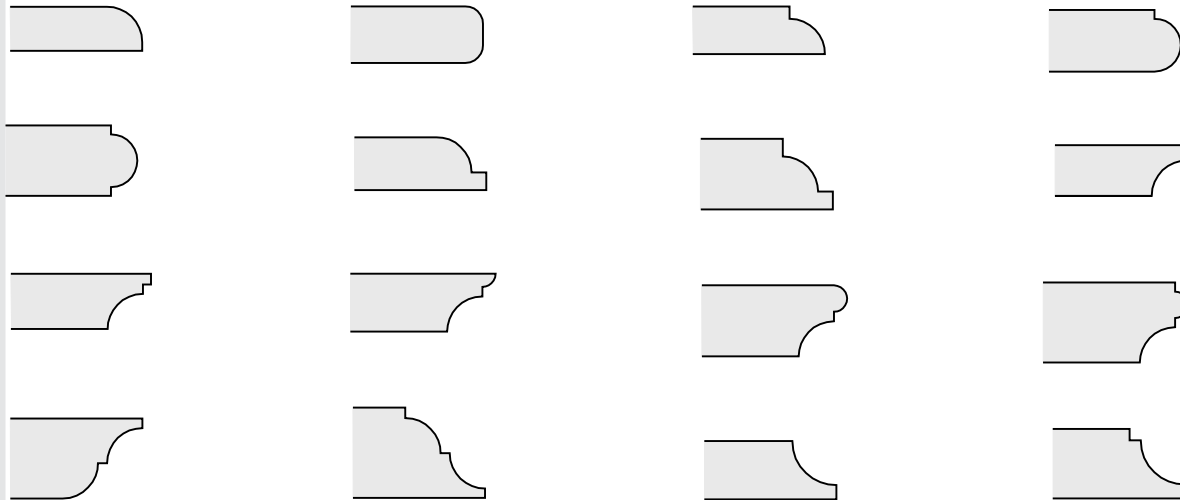

2 operations

several operations

150508

### Grooving Turnover Knives with 4 cutting edges

Product

Drawing

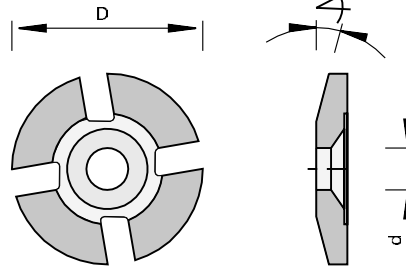

Tungsten Carbide [HW]

Machine / Application

| for use in miter glue joint cutterheads

Design

| cutting material: HW  
| HL Solid 15 for wood-based panels, hard and soft woods

Advantages

| very accurate profiling for optimum glue joints

Notes

| in conjunction with profile knife Ident-No.165916  
| packing unit: 10 pieces

| chamfer   | Ø D        | S           | Ø d         | Ident-No. |
|-----------|------------|-------------|-------------|-----------|
| 15<br>[°] | 25<br>[mm] | 4.6<br>[mm] | 5,4<br>[mm] | 165918    |

150578

### Chamfering Profile Knives with 4 cutting edges

Product

Drawing

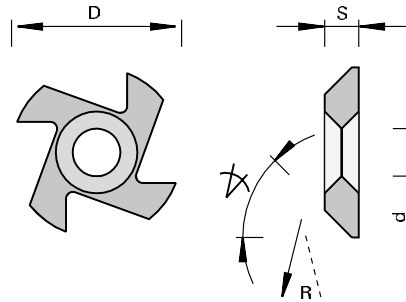

Tungsten Carbide [HW]

Machine / Application

| for use in cutterheads for chamfering

Design

| cutting material: HW  
| HL Solid 15 for wood-based panels, hard and soft woods

Advantages

Notes

| packing unit: 10 pieces

| chamfer   | Ø D        | S         | Ø d       | Ident-No. [L] | Ident-No. [R] |
|-----------|------------|-----------|-----------|---------------|---------------|
| 45<br>[°] | 25<br>[mm] | 5<br>[mm] | 7<br>[mm] | 165966        | 165965        |

150508

### Grooving Turnover Knives with 4 cutting edges

|         |             |                           |
|---------|-------------|---------------------------|
| Product | Drawing<br> | <br>Tungsten Carbide [HW] |
|---------|-------------|---------------------------|

| Machine / Application           | Design   | Advantages | Notes   |
|---------------------------------|--|------------|---|
| for use in grooving cutterheads | cutting material: HW<br>  HL Solid 15 for wood-based panels, hard and soft woods |            | Ident-No. 163699 for groove width 4 mm<br>  Ident-No. 165906 for groove width 5 mm<br>  Ident-No. 169250 for groove width > 7 mm<br>  packing unit: 10 pieces |

| B    | H    | S    | Ø d  | Ident-No. |
|------|------|------|------|-----------|
| 18   | 18   | 1.95 | 10   | 163699    |
| 18   | 18   | 2.5  | 10   | 165906    |
| 18   | 18   | 3.7  | 10   | 169250    |
| [mm] | [mm] | [mm] | [mm] |           |

150508 / 150509

### Grooving Turnover Knives with 2 cutting edges

|         |             |                           |
|---------|-------------|---------------------------|
| Product | Drawing<br> | <br>Tungsten Carbide [HW] |
|---------|-------------|---------------------------|

| Machine / Application               | Design  | Advantages | Notes                   |
|-------------------------------------|---|------------|-------------------------|
| for use in cutterheads for grooving | bore countersunk 90 degrees<br>  cutting material: HW<br>  HL Solid 30 for hard and soft woods<br>  HL Solid 40 for hard and soft woods |            | packing unit: 10 pieces |

| B    | H    | S    | Ø d  | Tmax | LEUCODUR    | Ident-No. |
|------|------|------|------|------|-------------|-----------|
| 13   | 36   | 3.5  | 7,4  | 10   | HL Solid 30 | 165968    |
| 16   | 34   | 3.2  | 6,7  | 8    | HL Solid 40 | 173484    |
| 16   | 34   | 4    | 6,7  | 8    | HL Solid 40 | 173485    |
| 16   | 34   | 5    | 6,7  | 8    | HL Solid 40 | 173486    |
| [mm] | [mm] | [mm] | [mm] | [mm] |             |           |

150578

### Chamfering Profile Knives with 4 cutting edges

Product

Drawing

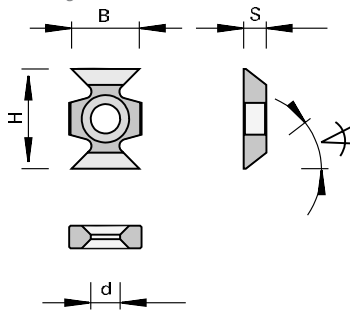

Tungsten Carbide [HW]

Machine / Application

| for use in cutterheads for chamfering

Design

| cutting material: HW  
| HL Solid 15 for wood-based panels, hard and soft woods

Advantages

Notes

| for left and right hand rotation  
| spacer rings for the adjustment of the chamfer knives  
see chapter replacement parts  
| packing unit: 10 pieces

| chamfer∠  | B          | H          | S         | ∅ d         | Ident-No. |
|-----------|------------|------------|-----------|-------------|-----------|
| 45<br>[°] | 16<br>[mm] | 22<br>[mm] | 5<br>[mm] | 6,5<br>[mm] | 176416    |

150578

### Rounding Turnover Knives with 4 cutting edges

Product

Drawing

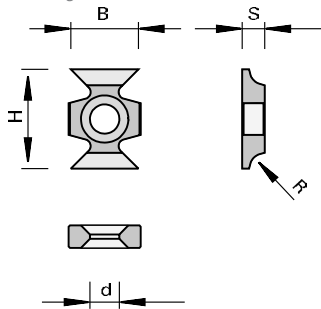

Tungsten Carbide [HW]

Machine / Application

| for use in cutterheads for rounding

Design

| cutting material: HW  
| HL Solid 15 for wood-based panels, hard and soft woods

Advantages

Notes

| for left and right hand rotation  
| spacer rings for the adjustment of the rounding knives  
see chapter replacement parts  
| packing unit: 10 pieces

| R           | B          | H          | S         | ∅ d         | Ident-No. |
|-------------|------------|------------|-----------|-------------|-----------|
| 1,5<br>[mm] | 16<br>[mm] | 22<br>[mm] | 5<br>[mm] | 6,5<br>[mm] | 176417    |
| 2           | 16         | 22         | 5         | 6,5         | 176418    |
| 2,5         | 16         | 22         | 5         | 6,5         | 176419    |
| 3           | 16         | 22         | 5         | 6,5         | 176420    |

132891

### Scraper Holders - Homag, Reich, IMA

Product



Drawing

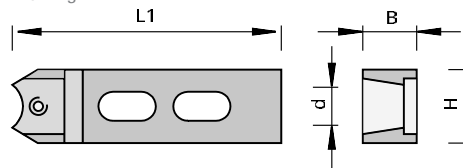

Tungsten Carbide [HW]

Machine / Application

l edge banding machines  
Homag, Reich  
l for installation of LEUCODUR  
radius-, chamfering- and  
scraper turnover knives

Design

Advantages

Notes

|           | B    | H    | Ø d  | L1   |              | Ident-No. |
|-----------|------|------|------|------|--------------|-----------|
| for R ≤ 5 | 15   | 16   | 6,5  | 131  | Homag, Reich | 169252    |
| for R ≤ 5 | 22   | 14   | 6,5  | 118  | Homag        | 179463    |
|           | [mm] | [mm] | [mm] | [mm] |              |           |

Spare parts

Dimension

Class-No.

Ident-No.

|                   |            |        |        |
|-------------------|------------|--------|--------|
| Round Head Screws | M4x5,9 T15 | 995195 | 167966 |
| Screwdrivers      | T15        | 985730 | 163161 |
| Screwdrivers      | T15x80     | 985730 | 171188 |
|                   | [mm]       |        |        |

151555

### Scraper Turnover Knives with 2 cutting edges and chamfer - Homag, IMA, Reich

Product

Drawing

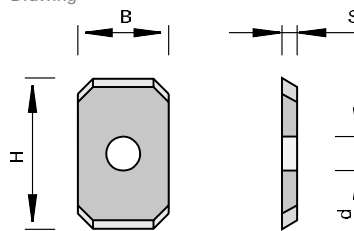

Tungsten Carbide [HW]

Machine / Application

l edge banding machines  
Homag, IMA, Reich  
l for use in scraper holders

Design

l chamfer angle 45 degrees  
l cutting material: HW  
l HL Board 05 for wood-based  
panels, plastics and hard  
woods

Advantages

Notes

l packing unit: 10 pieces

| B    | H    | S    | Ø d  | Ident-No. |
|------|------|------|------|-----------|
| 12   | 20   | 2    | 4    | 171180    |
| [mm] | [mm] | [mm] | [mm] |           |

151555

### Scrapper Turnover Knives with 2 cutting edges and radius - Homag, Reich

Product

Drawing

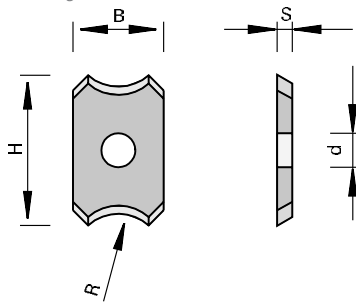

Tungsten Carbide [HW]

Machine / Application

| edge banding machines  
Homag, Reich  
| for use in scraper holders

Design

| 6 degree profile run-out  
| cutting material: HW  
| HL Board 05 for wood-based panels, plastics and hard woods

Advantages

Notes

| packing unit: 10 pieces

| R    | B    | H    | S    | Ø d  | Ident-No. |
|------|------|------|------|------|-----------|
| 0,8  | 12   | 20   | 2    | 4    | 171401 s  |
| 1    | 12   | 20   | 2    | 4    | 169253    |
| 1,5  | 12   | 20   | 2    | 4    | 169254    |
| 2    | 12   | 20   | 2    | 4    | 169255    |
| 2,5  | 12   | 20   | 2    | 4    | 169256    |
| 3    | 12   | 20   | 2    | 4    | 169257    |
| 4    | 12   | 20   | 2    | 4    | 169259    |
| 5    | 12   | 20   | 2    | 4    | 169261    |
| [mm] | [mm] | [mm] | [mm] | [mm] |           |

151555

### Scrapper Turnover Knives with 2 cutting edges and radius - IMA

Product

Drawing

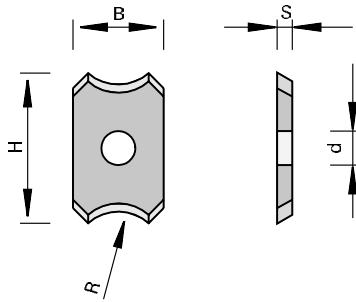

Tungsten Carbide [HW]

Machine / Application

| edge banding machines IMA  
| for use in scraper holders

Design

| 15 degree profile run-out  
| cutting material: HW  
| HL Board 05 for wood-based panels, plastics and hard woods

Advantages

Notes

| packing unit: 10 pieces

| R    | B    | H    | S    | Ø d  | Ident-No. |
|------|------|------|------|------|-----------|
| 1    | 12   | 20   | 2    | 4    | 178856    |
| 2    | 12   | 20   | 2    | 4    | 178957    |
| 3    | 12   | 20   | 2    | 4    | 178857    |
| [mm] | [mm] | [mm] | [mm] | [mm] |           |



151755

### Scrapper Turnover Knives with 2 cutting edges and radius - Homag

Product

Drawing

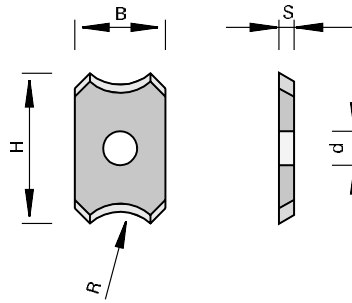

Tungsten Carbide [HW]

Machine / Application

| edge banding machines  
Homag  
| for use in scraper holders

Design

| 6 degree profile run-out  
| special scraper which avoids material fracturing  
| cutting material: HW  
| HL Board 05 for wood-based panels, plastics and hard woods

Advantages

| no material fracturing also in the case of PP-edges  
| no additional work steps needed

Notes

| packing unit: 10 pieces

| R    | B    | H    | S    | Ø d  | Ident-No. |
|------|------|------|------|------|-----------|
| 1,5  | 12   | 20   | 2    | 4    | 181234    |
| 2    | 12   | 20   | 2    | 4    | 181235    |
| 3    | 12   | 20   | 2    | 4    | 181237    |
| [mm] | [mm] | [mm] | [mm] | [mm] |           |

151755

### Scrapper Turnover Knives with 2 cutting edges and radius - IMA

Product

Drawing

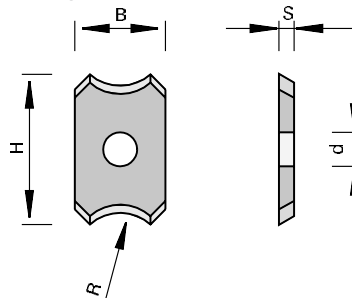

Tungsten Carbide [HW]

Machine / Application

| edge banding machines IMA  
| for use in scraper holders

Design

| 6 degree profile run-out  
| special scraper which avoids material fracturing  
| cutting material: HW  
| HL Board 05 for wood-based panels, plastics and hard woods

Advantages

| no material fracturing also in the case of PP-edges  
| no additional work steps needed

Notes

| packing unit: 10 pieces

| R    | B    | H    | S    | Ø d  | Ident-No. |
|------|------|------|------|------|-----------|
| 2    | 12   | 20   | 2    | 4    | 181236    |
| 3    | 12   | 20   | 2    | 4    | 181238    |
| [mm] | [mm] | [mm] | [mm] | [mm] |           |

151586

### Scrapper Knives with 2 cutting edges and radius - working centers

Product

Drawing

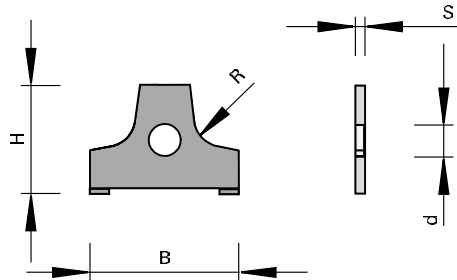

Tungsten Carbide [HW]

Machine / Application

l machines Homag combined with flush cutting unit No. 1-056-11-0621

Design

l 6 degree profile run-out  
l cutting material: HW  
l HL Board 06 for wood-based panels, plastics and soft woods

Advantages

Notes

l packing unit: 10 pieces

| R    | B    | H    | S    | Ø d  | Ident-No. |
|------|------|------|------|------|-----------|
| 1,5  | 20   | 11.5 | 2    | 5    | 180025    |
| 2    | 20   | 11.5 | 2    | 5    | 180020    |
| 2,5  | 20   | 11.5 | 2    | 5    | 180021    |
| 3    | 20   | 11.5 | 2    | 5    | 180022    |
| [mm] | [mm] | [mm] | [mm] | [mm] |           |

151586

### Scrapper Knives with 2 cutting edges and chamfer (glue joint) - working centers

Product

Drawing

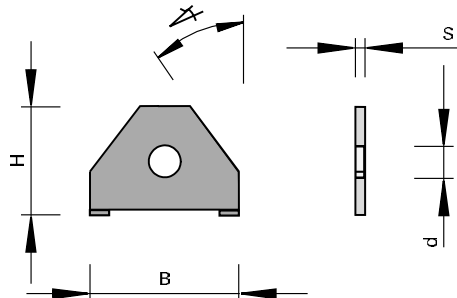

Tungsten Carbide [HW]

Machine / Application

l machines Homag combined with flush cutting unit No. 1-056-11-0621

Design

l cutting material: HW  
l HL Board 06 for wood-based panels, plastics and soft woods

Advantages

Notes

l packing unit: 10 pieces

| chamfer | B    | H    | S    | Ø d  | Ident-No. |
|---------|------|------|------|------|-----------|
| 3       | 20   | 11.5 | 2    | 5    | 180023    |
| 15      | 20   | 11.5 | 2    | 5    | 180210 #  |
| 30      | 20   | 11.5 | 2    | 5    | 180211 #  |
| [°]     | [mm] | [mm] | [mm] | [mm] |           |

151586

### Chip Breaker for Scraper Knives



|   |         |
|---|---------|
| Product   | Drawing |
|  |         |
| Tungsten Carbide [HW]   |         |

| Machine / Application   | Design   | Advantages | Notes                   |
|---|--|------------|-------------------------|
| machines Homag combined with flush cutting unit No. 1-056-11-0621 | 6 degree profile run-out<br>  cutting material: HW<br>  HL Board O6 for wood-based panels, plastics and soft woods |            | packing unit: 10 pieces |

| R    | B    | H    | S    | Ø d  | Ident-No. |
|------|------|------|------|------|-----------|
| 1,3  | 20   | 11.5 | 2    | 5    | 180024    |
| [mm] | [mm] | [mm] | [mm] | [mm] |           |

151586

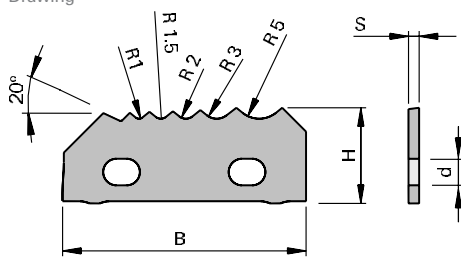
### Scrapers Knives with 5 radii and chamfer

|   |         |
|---|---------|
| Product   | Drawing |
|   |         |
|  |         |
| Tungsten Carbide [HW]   |         |

| Machine / Application                        | Design   | Advantages | Notes   |
|--|--|------------|---|
| machines Homag with scraping unit Type MN 20 | chamfer 20 in degree, R1, R1,5, R2, R3, R5<br>  cutting material: HW<br>  HL Board O6 for wood-based panels, plastics and soft woods |            | Ident-No. 180755 can be applied on the left lower or the right upper side<br>  Ident-No. 180754 can be applied on the left upper or the right lower side<br>  packing unit: 10 pieces |

| R    | B    | H     | S    | Ø d  | Ident-No. [L] | Ident-No. [R] |
|------|------|-------|------|------|---------------|---------------|
| 1-5  | 45,8 | 17.98 | 2    | 5    | 180755        | 180754        |
| [mm] | [mm] | [mm]  | [mm] | [mm] |               |               |

151786

### Scrapper Knives with 5 radii and chamfer

Product

Drawing

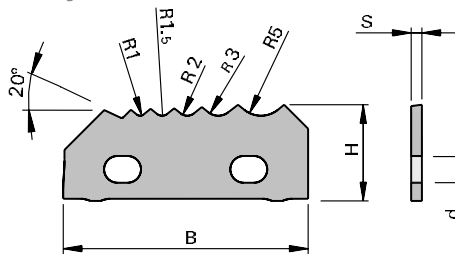

LEUCO  
topline

LEUCO  
DUR

Tungsten Carbide [HW]

Machine / Application

l machines Homag with scraping unit Type MN 20

Design

l chamfer 20 in degree, R1, R1,5, R2, R3, R5  
l special scrapper which avoids material fracturing  
l cutting material: HW  
l HL Board O6 for wood-based panels, plastics and soft woods

Advantages

l no material fracturing also in the case of PP-edges  
l no additional work steps needed

Notes

l Ident-No. 181239 can be applied on the left lower or the right upper side  
l Ident-No. 181240 can be applied on the left upper or the right lower side  
l packing unit: 10 pieces

| R    | B    | H     | S    | Ø d  | Ident-No. [L] | Ident-No. [R] |
|------|------|-------|------|------|---------------|---------------|
| 1-5  | 45,8 | 17,98 | 2    | 5    | 181240        | 181239        |
| [mm] | [mm] | [mm]  | [mm] | [mm] |               |               |

151548

### Scrapper Knives with 1 cutting edge and chamfer

Product

Drawing

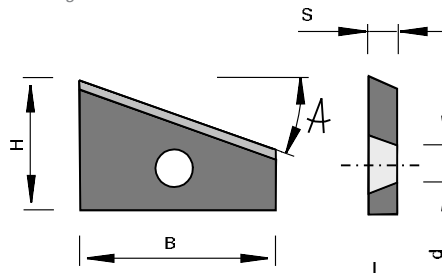

LEUCO  
DUR

Tungsten Carbide [HW]

Machine / Application

l machines IMA units 181.91 and 0.6126 (BAZ) with 30 mm width, unit 08.50 with 55 mm width

Design

l cutting material: HW  
l HL Solid 15 for wood-based panels, hard and soft woods

Advantages

Notes

l packing unit: 10 pieces

| chamfer | B    | H    | S    | Ø d  | Ident-No. [L] | Ident-No. [R] |
|---------|------|------|------|------|---------------|---------------|
| 15      | 30   | 22,5 | 3    | 5,8  | 178859        | 178858        |
| 15      | 55   | 25   | 3    | 5,8  | 178861        | 178860        |
| [°]     | [mm] | [mm] | [mm] | [mm] |               |               |

132821

## Scrapper Knives with 1 cutting edge and chamfer

Product

Drawing

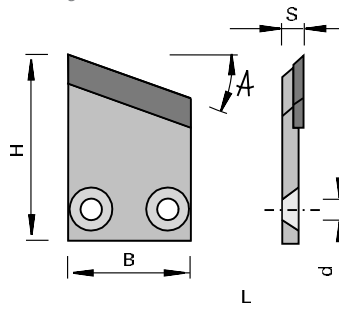

Tungsten Carbide [HW]

Machine / Application

| machines Homag

Design

| HW-tipped  
| cutting material: HW  
| HL Solid 15 for wood-based panels, hard and soft woods

Advantages

Notes

| packing unit: 10 pieces

| chamfer $\sphericalangle$ | B    | H    | S    | $\varnothing d$ | Ident-No. [L] | Ident-No. [R] |
|---------------------------|------|------|------|-----------------|---------------|---------------|
| 15                        | 32   | 55   | 4.5  | 5,8             | 178223        | 178224        |
| [°]                       | [mm] | [mm] | [mm] | [mm]            |               |               |

150503

## Cup Knives

Product



Drawing

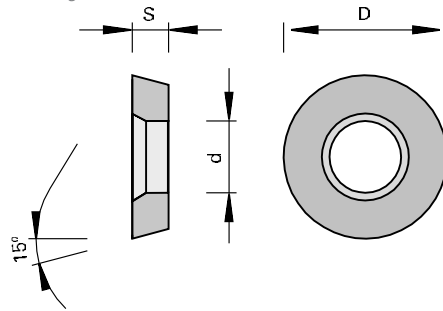

LEUCO  
DUR

Tungsten Carbide [HW]

Machine / Application

| for use in side-and-face  
cutterheads

Design

| cutting material: HW  
| HL Board O3 for wood-based  
panels and plastics

Advantages

| optimum edge lives

Notes

| packing unit: 10 pieces

Ø D      S      Ø d

Ident-No.

11      4      5

173396

[mm]      [mm]      [mm]

153306 / 153308

## HW Saw Teeth for Circular Saw Blades - solder coated

Product

Drawing

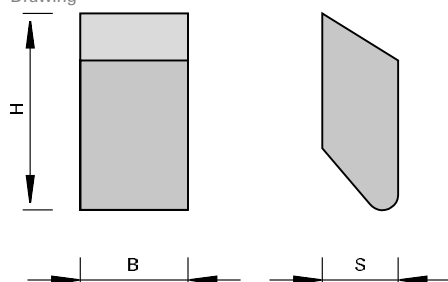
LEUCO  
DUR

Tungsten Carbide [HW]

Machine / Application

Design

Advantages

Notes

| solder-coated  
 | cutting material: HW  
 | HL Board 06 for wood-based panels, plastics and soft woods  
 | HL Solid 15 for wood-based panels, hard and soft woods

| easy soldering during tooth installation thanks to solder coating

| B    | H    | S    | LEUCODUR    | Ident-No. |
|------|------|------|-------------|-----------|
| 2,7  | 7.1  | 2    | HL Board 06 | 177493    |
| 2,8  | 8    | 2.3  | HL Solid 15 | 177500    |
| 3,6  | 8    | 2.3  | HL Board 06 | 177494    |
| 4,2  | 10.5 | 3.5  | HL Solid 15 | 177501    |
| 4,5  | 8    | 2.3  | HL Board 06 | 177495    |
| 4,3  | 10.5 | 3    | HL Board 06 | 177496    |
| 5    | 10.5 | 3    | HL Board 06 | 177497    |
| 5,4  | 10.5 | 3    | HL Board 06 | 177498    |
| 6    | 12.5 | 4    | HL Solid 15 | 177586    |
| 6,8  | 12.5 | 4    | HL Board 06 | 177499    |
| [mm] | [mm] | [mm] |             |           |

132121

## Planing Knives HW

Product

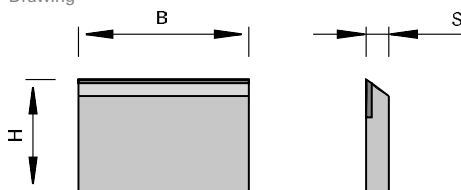

Drawing

LEUCO  
DUR

Tungsten Carbide [HW]

Machine / Application

I for use in planing cutterheads  
for hard woods

Design

I HW-tipped

Advantages

Notes

| B    | H    | S    | Ident-No. |
|------|------|------|-----------|
| 60   | 30   | 3    | 160586    |
| 80   | 30   | 3    | 006204    |
| 100  | 30   | 3    | 006205    |
| 110  | 30   | 3    | 165329 o  |
| 120  | 30   | 3    | 006206 o  |
| 130  | 30   | 3    | 006207    |
| 150  | 30   | 3    | 006208    |
| 170  | 30   | 3    | 006209    |
| 180  | 30   | 3    | 055649    |
| 210  | 30   | 3    | 006210 o  |
| 230  | 30   | 3    | 160588    |
| 240  | 30   | 3    | 182641    |
| 260  | 30   | 3    | 160589 o  |
| 310  | 30   | 3    | 055648    |
| 310  | 35   | 3    | 165338 o  |
| 320  | 30   | 3    | 165330 o  |
| 320  | 35   | 3    | 165339 o  |
| 330  | 30   | 3    | 165331 o  |
| 330  | 35   | 3    | 165340 o  |
| 360  | 30   | 3    | 165332 o  |
| 360  | 35   | 3    | 165341 o  |
| 400  | 35   | 3    | 165342 o  |
| 410  | 30   | 3    | 006211    |
| 410  | 35   | 3    | 165343 o  |
| 450  | 30   | 3    | 165333 o  |
| 450  | 35   | 3    | 165344 o  |
| 460  | 30   | 3    | 165334 o  |
| 460  | 35   | 3    | 165345 o  |
| 500  | 35   | 3    | 165346 o  |
| 510  | 30   | 3    | 006212    |
| 510  | 35   | 3    | 165347 o  |
| 600  | 35   | 3    | 165348 o  |
| 610  | 30   | 3    | 006704    |
| 610  | 35   | 3    | 165349 o  |
| 630  | 30   | 3    | 165335 o  |
| 630  | 35   | 3    | 165350 o  |
| 635  | 35   | 3    | 165351 o  |
| 640  | 30   | 3    | 165336 o  |
| 640  | 35   | 3    | 165352 o  |
| 700  | 35   | 3    | 165353 o  |
| 710  | 30   | 3    | 160590 o  |
| 710  | 35   | 3    | 165354 o  |
| 740  | 30   | 3    | 165337 o  |
| [mm] | [mm] | [mm] |           |



| B    | H    | S    | Ident-No. |
|------|------|------|-----------|
| 740  | 35   | 3    | 165355 o  |
| 810  | 30   | 3    | 160592    |
| 810  | 35   | 3    | 165356 o  |
| [mm] | [mm] | [mm] |           |

332121

## Planing Knives HS

Product



Drawing

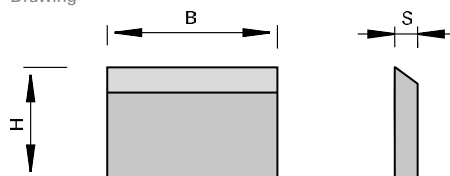

High Speed Steel [HS]

Machine / Application

Design

Advantages

Notes

l for use in planing cutterheads  
for soft woods

| B    | H    | S    | Ident-No. |
|------|------|------|-----------|
| 60   | 30   | 3    | 160593    |
| 80   | 30   | 3    | 160594    |
| 100  | 30   | 3    | 055647    |
| 110  | 30   | 3    | 160595 o  |
| 120  | 30   | 3    | 160596    |
| 130  | 30   | 3    | 006139    |
| 150  | 30   | 3    | 160597    |
| 170  | 30   | 3    | 160598    |
| 180  | 30   | 3    | 160599    |
| 210  | 30   | 3    | 160600    |
| 230  | 30   | 3    | 160601    |
| 260  | 30   | 3    | 006485    |
| 310  | 30   | 3    | 160602    |
| 310  | 35   | 3    | 165310    |
| 320  | 30   | 3    | 160603    |
| 320  | 35   | 3    | 165311 o  |
| 330  | 30   | 3    | 160604 o  |
| 330  | 35   | 3    | 165312    |
| 360  | 30   | 3    | 160605 o  |
| 360  | 35   | 3    | 165313 o  |
| 400  | 30   | 3    | 165307    |
| 400  | 35   | 3    | 165314 o  |
| 410  | 30   | 3    | 006486    |
| 410  | 35   | 3    | 006487    |
| 450  | 30   | 3    | 160606 o  |
| 450  | 35   | 3    | 165315 o  |
| 460  | 30   | 3    | 160607 o  |
| 460  | 35   | 3    | 165316 o  |
| 500  | 30   | 3    | 165308    |
| 500  | 35   | 3    | 165317    |
| 510  | 30   | 3    | 006488    |
| 510  | 35   | 3    | 006489    |
| 600  | 30   | 3    | 165309 o  |
| 600  | 35   | 3    | 165318 o  |
| 610  | 30   | 3    | 006490    |
| 610  | 35   | 3    | 006491    |
| 630  | 30   | 3    | 160608    |
| [mm] | [mm] | [mm] |           |

## Planing Knives

| B    | H    | S    | Ident-No. |
|------|------|------|-----------|
| 630  | 35   | 3    | 165319    |
| 635  | 35   | 3    | 165320 o  |
| 640  | 30   | 3    | 160609    |
| 640  | 35   | 3    | 165321    |
| 700  | 35   | 3    | 165322 o  |
| 710  | 30   | 3    | 160610 o  |
| 710  | 35   | 3    | 165323 o  |
| 740  | 35   | 3    | 165324 o  |
| 810  | 30   | 3    | 160612    |
| 810  | 35   | 3    | 165325    |
| 840  | 30   | 3    | 160613 o  |
| 1050 | 30   | 3    | 176331    |
| 1050 | 35   | 3    | 176332    |
| 1200 | 30   | 3    | 180535    |
| [mm] | [mm] | [mm] |           |

332124

## Planing Knives HS

Product



Drawing

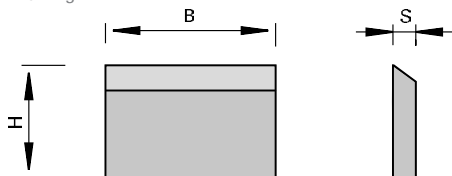

**LEUCO**  
topcoat

High Speed Steel [HS]

Machine / Application

| for use in planing cutterheads  
for soft woods

Design

| Topcoat coating

Advantages

| compared to traditional HS the  
edge live is 3 - 5 times as long

Notes

| packing unit: 2 pieces

| B    | H    | S    | Ident-No. |
|------|------|------|-----------|
| 60   | 30   | 3    | 181264 o  |
| 80   | 30   | 3    | 181265 o  |
| 100  | 30   | 3    | 181266 o  |
| 110  | 30   | 3    | 181267 o  |
| 120  | 30   | 3    | 181268 o  |
| 130  | 30   | 3    | 181269 o  |
| 150  | 30   | 3    | 181270 o  |
| 170  | 30   | 3    | 181271 o  |
| 180  | 30   | 3    | 181272 o  |
| 210  | 30   | 3    | 181273 o  |
| 230  | 30   | 3    | 181274 o  |
| 260  | 30   | 3    | 181275 o  |
| 310  | 30   | 3    | 181276 o  |
| 310  | 35   | 3    | 181277 o  |
| 320  | 30   | 3    | 181278 o  |
| 320  | 35   | 3    | 181279 o  |
| 330  | 30   | 3    | 181280 o  |
| 330  | 35   | 3    | 181281 o  |
| 360  | 30   | 3    | 181282 o  |
| 360  | 35   | 3    | 181283 o  |
| 400  | 30   | 3    | 181284 o  |
| 400  | 35   | 3    | 181285 o  |
| 410  | 30   | 3    | 181286 o  |
| 410  | 35   | 3    | 181287 o  |
| 450  | 30   | 3    | 181288 o  |
| 450  | 35   | 3    | 181289 o  |
| [mm] | [mm] | [mm] |           |

| B    | H    | S    | Ident-No. |
|------|------|------|-----------|
| 460  | 30   | 3    | 181290 o  |
| 460  | 35   | 3    | 181291 o  |
| 500  | 30   | 3    | 181292 o  |
| 500  | 35   | 3    | 181293 o  |
| 510  | 30   | 3    | 181294 o  |
| 510  | 35   | 3    | 181295 o  |
| 600  | 30   | 3    | 181296 o  |
| 600  | 35   | 3    | 181297 o  |
| 610  | 30   | 3    | 181298 o  |
| 610  | 35   | 3    | 181299 o  |
| 630  | 30   | 3    | 181300 o  |
| 630  | 35   | 3    | 181301 o  |
| 635  | 35   | 3    | 181302 o  |
| 640  | 30   | 3    | 181303 o  |
| 640  | 35   | 3    | 181304 o  |
| 700  | 35   | 3    | 181305 o  |
| 710  | 30   | 3    | 181306 o  |
| 710  | 35   | 3    | 181307 o  |
| 740  | 35   | 3    | 181308 o  |
| 810  | 30   | 3    | 181309 o  |
| 810  | 35   | 3    | 181310 o  |
| 840  | 30   | 3    | 181311 o  |
| 1050 | 30   | 3    | 181312 o  |
| 1050 | 35   | 3    | 181313 o  |
| [mm] | [mm] | [mm] |           |

152548

### SetProfiler set - planing

Product

Drawing

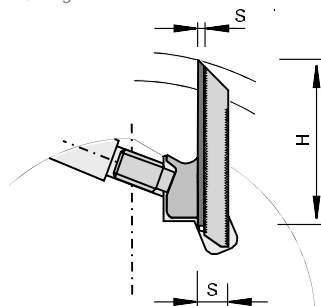

LEUCO  
topcoat

LEUCO  
DUR

Tungsten Carbide [HW]

Machine / Application

- | molders
- | for use in profile cutterheads with serration

Design

- | n max = 12.000 min-1
- | cutting material: HW
- | HL Solid 30 Topline for hard and soft woods
- | HW Topcoat
- | Topline (polished surface)

Advantages

- | long edge life and optimum cutting quality thanks to TOPLINE design
- | compared to uncoated HW-Blanks the edge lives is 2 - 3 times as long
- | adjustable knives by means of serration between knife and support plate; 5 adjustments of 1,6 mm = 8 mm sharpening area

Notes

- | packing unit: 2 pieces

| B    | H    | S    | Ident-No. |
|------|------|------|-----------|
| 310  | 38   | 10   | 181974 o  |
| [mm] | [mm] | [mm] |           |

| Blanks            | B    | H    | Z    | Class-No. | Ident-No. |
|-------------------|------|------|------|-----------|-----------|
| HW Blanks         | 310  | 38   | 3.2  | 152548    | 181975o   |
| HW Topcoat Blanks | 250  | 38   | 3.2  | 152548    | 181976o   |
|                   | [mm] | [mm] | [mm] |           |           |

## Planing Knives

|                |      |                           |           |           |
|----------------|------|---------------------------|-----------|-----------|
| support plates | B    | suitable for blank height | Class-No. | Ident-No. |
|                | 250  | 38                        | 925400    | 181977o   |
|                | 310  | 38                        | 925400    | 181978o   |
|                | [mm] | [mm]                      |           |           |

332511

### Planing Knives with serrated back HS

Product



Drawing

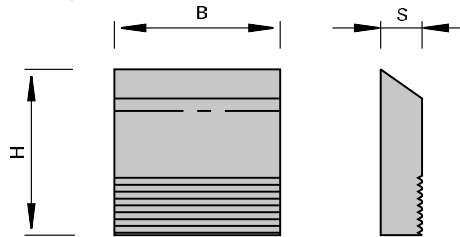

High Speed Steel [HS]

Machine / Application

I for use in cutterheads with serration

Design

I cutting material: HS for soft woods

Advantages

Notes

I also for Weing Powermat machines, RPM up to 12,000 min-1  
I packing unit: 2 pieces

Notes for sales staff

I with 12,000 min-1 standard planing knives are not permitted because of the high centrifugal forces

| B    | H    | S    | Ident-No. |
|------|------|------|-----------|
| 100  | 38   | 5    | 182096 s  |
| 130  | 38   | 5    | 182097 s  |
| 170  | 38   | 5    | 182098 s  |
| 190  | 38   | 5    | 182099 s  |
| 230  | 38   | 5    | 182100 s  |
| 240  | 38   | 5    | 182101 s  |
| [mm] | [mm] | [mm] |           |

152548

## SetProfiler set - profiling

Product

Drawing

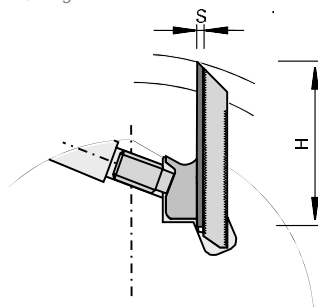
LEUCO  
topcoatLEUCO  
DUR

Tungsten Carbide [HW]

Machine / Application

l molders  
l for use in profile cutterheads  
with serration

Design

l cutting material: HW  
l HL Solid 30 Topline for hard  
and soft woods  
l HW Topcoat  
l Topline (polished surface)

Advantages

l long edge life and optimum  
cutting quality thanks to  
TOPLINE design  
l compared to uncoated HW-  
Blanks the edge lives is 2 - 3  
times as long  
l high economic efficiency thanks  
to reduced use of grinding  
wheels, as knives and support  
plates are profiled separately  
whereas only the knives are  
re-ground  
l adjustable knives by means of  
serration between knife and  
support plate; 5 adjustments  
of 1,6 mm = 8 mm sharpening  
area

Notes

l serration 60 degrees and  
partition 1,6 mm for profiling  
of solid woods and wood-  
based panels  
l blank height 50 and 60 mm  
for RPM up to 12.000 min-2  
l T = profile depth  
l packing unit: 2 pieces

| B    | H    | S    | Tmax | Ident-No. |
|------|------|------|------|-----------|
| 40   | 50   | 10   | 14   | 181637 o  |
| 50   | 50   | 10   | 14   | 181638 o  |
| 60   | 50   | 10   | 14   | 181639 o  |
| 70   | 50   | 10   | 14   | 181640 o  |
| 80   | 50   | 10   | 14   | 181641 o  |
| 100  | 50   | 10   | 14   | 182182 o  |
| 130  | 50   | 10   | 14   | 182183 o  |
| 150  | 50   | 10   | 14   | 182184 o  |
| 250  | 50   | 10   | 14   | 181642 o  |
| 40   | 60   | 10   | 24   | 181643 o  |
| 50   | 60   | 10   | 24   | 181644 o  |
| 60   | 60   | 10   | 24   | 181645 o  |
| 70   | 60   | 10   | 24   | 181646 o  |
| 80   | 60   | 10   | 24   | 181647 o  |
| 100  | 60   | 10   | 24   | 182322 o  |
| 130  | 60   | 10   | 24   | 182323 o  |
| 150  | 60   | 10   | 24   | 182324 o  |
| 250  | 60   | 10   | 24   | 181648 o  |
| 40   | 70   | 10   | 34   | 181649 o  |
| 50   | 70   | 10   | 34   | 181650 o  |
| 60   | 70   | 10   | 34   | 181651 o  |
| 70   | 70   | 10   | 34   | 181652 o  |
| 80   | 70   | 10   | 34   | 181653 o  |
| 250  | 70   | 10   | 34   | 181654 o  |
| [mm] | [mm] | [mm] | [mm] |           |

HW Blanks

| B    | H    | S    | T    | Class-No. | Ident-No. |
|------|------|------|------|-----------|-----------|
| 40   | 50   | 3.2  | 14   | 152548    | 181619    |
| 50   | 50   | 3.2  | 14   | 152548    | 181620 o  |
| 60   | 50   | 3.2  | 14   | 152548    | 181621    |
| 70   | 50   | 3.2  | 14   | 152548    | 181622    |
| [mm] | [mm] | [mm] | [mm] |           |           |

## Blanks

| HW Blanks         | B    | H                         | S    | T    | Class-No. | Ident-No. |
|-------------------|------|---------------------------|------|------|-----------|-----------|
|                   | 80   | 50                        | 3.2  | 14   | 152548    | 181623    |
|                   | 100  | 50                        | 3.2  | 14   | 152548    | 182179    |
|                   | 130  | 50                        | 3.2  | 14   | 152548    | 182180    |
|                   | 150  | 50                        | 3.2  | 14   | 152548    | 182181 o  |
|                   | 250  | 50                        | 3.2  | 14   | 152548    | 181624 o  |
|                   | 40   | 60                        | 3.2  | 24   | 152548    | 181625    |
|                   | 50   | 60                        | 3.2  | 24   | 152548    | 181626 o  |
|                   | 60   | 60                        | 3.2  | 24   | 152548    | 181627    |
|                   | 70   | 60                        | 3.2  | 24   | 152548    | 181628    |
|                   | 80   | 60                        | 3.2  | 24   | 152548    | 181629    |
|                   | 100  | 60                        | 3.2  | 24   | 152548    | 182319    |
|                   | 130  | 60                        | 3.2  | 24   | 152548    | 182320 o  |
|                   | 150  | 60                        | 3.2  | 24   | 152548    | 182321 o  |
|                   | 250  | 60                        | 3.2  | 24   | 152548    | 181630 o  |
|                   | 40   | 70                        | 3.2  | 34   | 152548    | 181631 o  |
|                   | 50   | 70                        | 3.2  | 34   | 152548    | 181632 o  |
|                   | 60   | 70                        | 3.2  | 34   | 152548    | 181633 o  |
|                   | 70   | 70                        | 3.2  | 34   | 152548    | 181634 o  |
|                   | 80   | 70                        | 3.2  | 34   | 152548    | 181635 o  |
|                   | 250  | 70                        | 3.2  | 34   | 152548    | 181636 o  |
|                   | [mm] | [mm]                      | [mm] | [mm] |           |           |
| HW Topcoat Blanks | B    | H                         | S    | T    | Class-No. | Ident-No. |
|                   | 40   | 50                        | 3.2  | 14   | 152548    | 181665    |
|                   | 50   | 50                        | 3.2  | 14   | 152548    | 181666 o  |
|                   | 60   | 50                        | 3.2  | 14   | 152548    | 181667    |
|                   | 70   | 50                        | 3.2  | 14   | 152548    | 181668    |
|                   | 80   | 50                        | 3.2  | 14   | 152548    | 181669 o  |
|                   | 100  | 50                        | 3.2  | 14   | 152548    | 182188 o  |
|                   | 130  | 50                        | 3.2  | 14   | 152548    | 182189 o  |
|                   | 150  | 50                        | 3.2  | 14   | 152548    | 182190 o  |
|                   | 250  | 50                        | 3.2  | 14   | 152548    | 181670 o  |
|                   | 40   | 60                        | 3.2  | 24   | 152548    | 181671    |
|                   | 50   | 60                        | 3.2  | 24   | 152548    | 181672    |
|                   | 60   | 60                        | 3.2  | 24   | 152548    | 181673    |
|                   | 70   | 60                        | 3.2  | 24   | 152548    | 181674 o  |
|                   | 80   | 60                        | 3.2  | 24   | 152548    | 181675    |
|                   | 100  | 60                        | 3.2  | 24   | 152548    | 182328    |
|                   | 130  | 60                        | 3.2  | 24   | 152548    | 182329 o  |
|                   | 150  | 60                        | 3.2  | 24   | 152548    | 182330 o  |
|                   | 250  | 60                        | 3.2  | 24   | 152548    | 181676 o  |
|                   | [mm] | [mm]                      | [mm] | [mm] |           |           |
| support plates    | B    | suitable for blank height |      |      | Class-No. | Ident-No. |
|                   | 40   | 50                        |      |      | 925400    | 181820    |
|                   | 50   | 50                        |      |      | 925400    | 181821 o  |
|                   | 60   | 50                        |      |      | 925400    | 181822    |
|                   | 70   | 50                        |      |      | 925400    | 181823    |
|                   | 80   | 50                        |      |      | 925400    | 181824    |
|                   | 100  | 50                        |      |      | 925400    | 182185    |
|                   | 130  | 50                        |      |      | 925400    | 182186    |
|                   | 150  | 50                        |      |      | 925400    | 182187 o  |
|                   | 250  | 50                        |      |      | 925400    | 181825 o  |
|                   | 40   | 60                        |      |      | 925400    | 181826    |
|                   | 50   | 60                        |      |      | 925400    | 181827    |
|                   | 60   | 60                        |      |      | 925400    | 181828    |
|                   | 70   | 60                        |      |      | 925400    | 181829    |
|                   | 80   | 60                        |      |      | 925400    | 181830    |
|                   | 100  | 60                        |      |      | 925400    | 182325    |
|                   | 130  | 60                        |      |      | 925400    | 182326 o  |
|                   | 150  | 60                        |      |      | 925400    | 182327 o  |
|                   | 250  | 60                        |      |      | 925400    | 181831 o  |
|                   | [mm] | [mm]                      |      |      |           |           |

| support plates | B    | suitable for blank height | Class-No. | Ident-No. |
|----------------|------|---------------------------|-----------|-----------|
|                | 40   | 70                        | 925400    | 181832o   |
|                | 50   | 70                        | 925400    | 181833o   |
|                | 60   | 70                        | 925400    | 181834o   |
|                | 70   | 70                        | 925400    | 181835o   |
|                | 80   | 70                        | 925400    | 181836o   |
|                | 250  | 70                        | 925400    | 181837o   |
|                | [mm] | [mm]                      |           |           |

132511

## Blanks with serrated back HW

Product

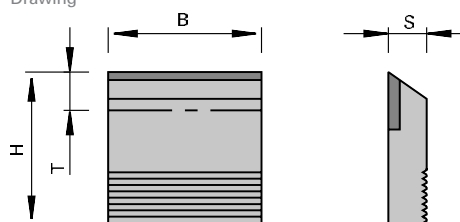

Drawing

LEUCO  
DUR

Tungsten Carbide [HW]

Machine / Application

l for use in profile cutterheads  
with serration

Design

l HW-tipped for hard and exotic  
woods  
l blank height 60 mm

Advantages

Notes

l T = profile depth  
l packing unit: 2 pieces

| B    | H    | S    | Tmax | Ident-No. |
|------|------|------|------|-----------|
| 40   | 50   | 10   | 13   | 165357 o  |
| 40   | 60   | 10   | 18   | 165365 o  |
| 60   | 50   | 10   | 13   | 165358 o  |
| 60   | 60   | 10   | 18   | 165366 o  |
| 80   | 50   | 10   | 13   | 165359 o  |
| 80   | 60   | 10   | 18   | 165367 o  |
| 100  | 50   | 10   | 13   | 165360 o  |
| 100  | 60   | 10   | 18   | 165368 o  |
| 130  | 50   | 10   | 13   | 165361 o  |
| 130  | 60   | 10   | 18   | 165369 o  |
| 150  | 50   | 10   | 13   | 165362 o  |
| 150  | 60   | 10   | 18   | 165370 o  |
| 180  | 50   | 10   | 13   | 165363 o  |
| 180  | 60   | 10   | 18   | 165371 o  |
| 230  | 50   | 10   | 13   | 165364 o  |
| 230  | 60   | 10   | 18   | 165372 o  |
| [mm] | [mm] | [mm] | [mm] |           |

332511

## Blanks with serrated back HS

Product

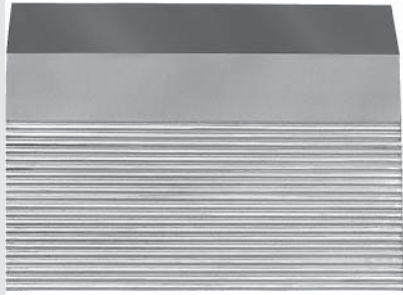

Drawing

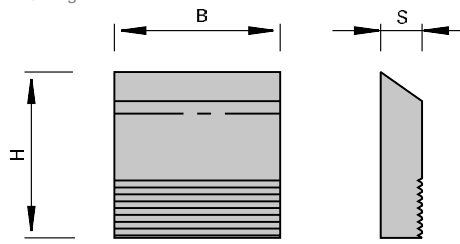

High Speed Steel [HS]

Machine / Application

I for use in profile cutterheads  
with serration

Design

I cutting material: HS for soft  
woods

Advantages

Notes

| B    | H    | S    | Ident-No. |
|------|------|------|-----------|
| 40   | 50   | 8    | 163385    |
| 40   | 60   | 8    | 163386    |
| 40   | 70   | 8    | 163387    |
| 50   | 50   | 8    | 180533    |
| 50   | 60   | 8    | 180534    |
| 60   | 50   | 8    | 163388    |
| 60   | 60   | 8    | 163389    |
| 60   | 70   | 8    | 163390    |
| 80   | 50   | 8    | 163391    |
| 80   | 60   | 8    | 163392    |
| 80   | 70   | 8    | 163393    |
| 100  | 50   | 8    | 163394    |
| 100  | 60   | 8    | 163395    |
| 100  | 70   | 8    | 163396    |
| 130  | 50   | 8    | 163397    |
| 130  | 60   | 8    | 163398    |
| 130  | 70   | 8    | 163399    |
| 150  | 50   | 8    | 163400    |
| 150  | 60   | 8    | 163401    |
| 150  | 70   | 8    | 163402    |
| 180  | 50   | 8    | 163403    |
| 180  | 60   | 8    | 163404    |
| 180  | 70   | 8    | 163405    |
| 230  | 50   | 8    | 164495    |
| 230  | 60   | 8    | 164496 o  |
| 650  | 50   | 8    | 176318    |
| 650  | 60   | 8    | 176319    |
| 650  | 70   | 8    | 176320    |
| [mm] | [mm] | [mm] |           |



332521

## Blanks HS and deflector blanks

Product

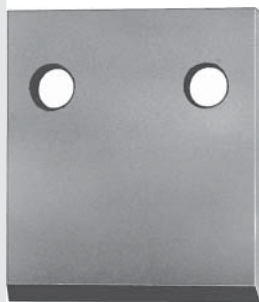

Drawing

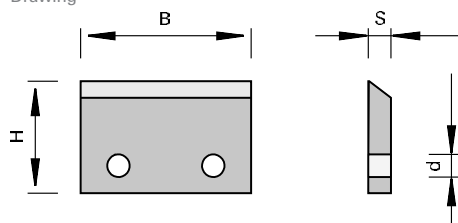

High Speed Steel [HS]

Machine / Application

| for use in safety cutterheads

Design

| cutting material: HS for soft woods  
| profile depth 15 mm max.

Advantages

Notes

| special steel deflector blanks

| B    | H    | S    | Ø d  | Ident-No. |
|------|------|------|------|-----------|
| 40   | 45   | 4    | 6    | 163535    |
| 40   | 45   | 4    | 6    | 163536    |
| [mm] | [mm] | [mm] | [mm] |           |

152555

## Blanks HW

Product

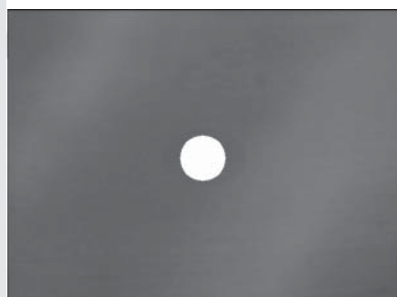

Drawing

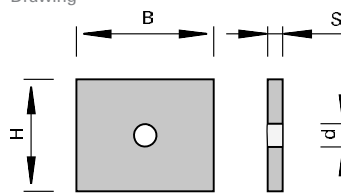
LEUCO  
DUR

Tungsten Carbide [HW]

Machine / Application

| for use in profile cutterheads

Design

| width, height, and thickness  
precision ground  
| cutting material: HW  
| HL Board 05 for wood-based panels, plastics and hard woods

Advantages

Notes

| packing unit: 10 pieces

| B    | H    | S    | Ø d  | L    | Ident-No. |
|------|------|------|------|------|-----------|
| 24   | 22   | 2    | 4,5  |      | 168821    |
| 28   | 24   | 2    | 4,2  |      | 168822    |
| 32   | 24   | 2    | 4,5  |      | 168823    |
| 36   | 28   | 2    | 4,2  |      | 168824    |
| 40   | 26   | 2    | 4,5  |      | 168825    |
| 42   | 32   | 2    | 4,5  | 24   | 168826    |
| 52   | 34   | 2    | 4,2  | 24   | 168828    |
| [mm] | [mm] | [mm] | [mm] | [mm] |           |

152555

### Blanks HW

Product

Drawing

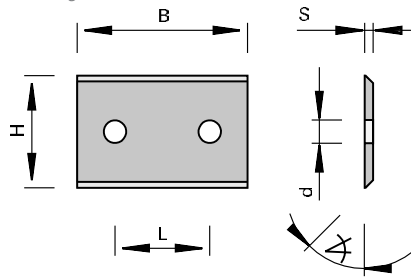

Tungsten Carbide [HW]

Machine / Application

| for use in profile cutterheads

Design

| width, height, and thickness  
| precision ground  
| cutting material: HW  
| HL Board O5 for wood-based  
| panels, plastics and hard  
| woods

Advantages

Notes

| packing unit: 10 pieces

| B    | H    | S    | Ø d  | L    | wedge◊ | Ident-No. |
|------|------|------|------|------|--------|-----------|
| 30   | 25   | 2    | 4,2  | 20   | 55     | 168871    |
| 40   | 30   | 2    | 4,2  | 20   | 55     | 168872    |
| 50   | 45   | 2    | 4,2  | 34   | 55     | 168873    |
| 60   | 25   | 2    | 4,2  | 26   | 55     | 168836    |
| 60   | 35   | 2    | 4,2  | 44   | 55     | 168837    |
| [mm] | [mm] | [mm] | [mm] | [mm] | [°]    |           |

152545

### Blanks HW

Product

Drawing

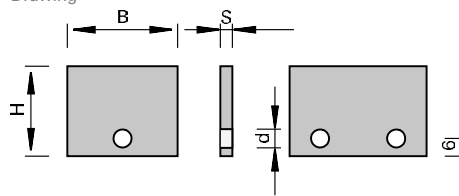
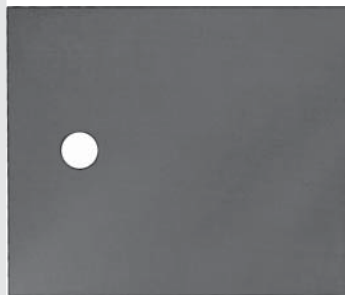

Tungsten Carbide [HW]

Machine / Application

| for use in profile cutterheads

Design

| width, height, and thickness  
| precision ground  
| cutting material: HW  
| HL Board O5 for wood-based  
| panels, plastics and hard  
| woods

Advantages

Notes

| packing unit: 10 pieces

| B    | H    | S    | Ø d  | L    | Ident-No. |
|------|------|------|------|------|-----------|
| 18   | 18.3 | 2    | 4,5  |      | 168829    |
| 20   | 25.3 | 2    | 4,2  |      | 168830    |
| 24   | 28.3 | 2    | 4,5  |      | 168831    |
| 32   | 22.3 | 2    | 4,5  |      | 168832    |
| 40   | 30.3 | 2    | 4,5  |      | 168833    |
| 50   | 32.3 | 2    | 4,5  | 24   | 168834    |
| [mm] | [mm] | [mm] | [mm] | [mm] |           |

152545

## Blanks HW

Product

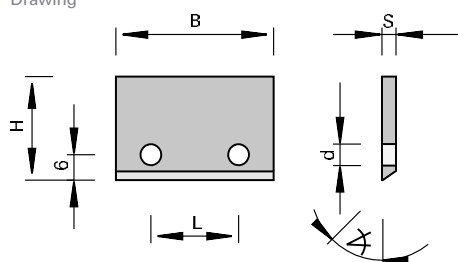

Drawing

LEUCO  
DUR

Tungsten Carbide [HW]

Machine / Application

| for use in profile cutterheads

Design

| width, height, and thickness  
| precision ground  
| cutting material: HW  
| HL Board O5 for wood-based  
panels, plastics and hard  
woods

Advantages

Notes

| packing unit: 10 pieces

| B    | H    | S    | Ø d  | L    | wedge-α | Ident-No. |
|------|------|------|------|------|---------|-----------|
| 40   | 20.5 | 2    | 4,2  | 26   | 55      | 168838    |
| 52   | 27.5 | 2    | 4,2  | 26   | 55      | 168839    |
| 60   | 39.5 | 2    | 4,2  | 44   | 55      | 168840    |
| [mm] | [mm] | [mm] | [mm] | [mm] | [°]     |           |

152586 / 152589

## 3P Blanks

Product

Drawing

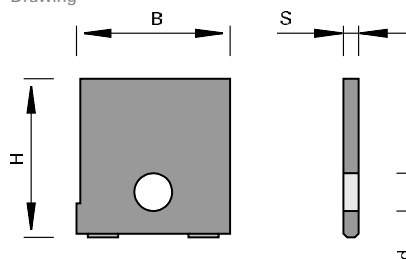
LEUCO  
DUR

Tungsten Carbide [HW]

Machine / Application

| for use in LEUCO EcoPro and  
special cutterheads

Design

| two-point seating surface and  
point-stop  
| cutting material: HW  
| HL Board O6 for wood-based  
panels, plastics and soft woods  
| HL Solid 60 for soft woods

Advantages

| precise positioning of the  
blanks for profiling and of the  
single-sided profile knife in the  
cutterhead

Notes

| profile knife can be profiled  
per customer specifications  
| packing unit: 10 pieces

| B    | H    | S    | Ø d  | LEUCODUR    | Ident-No. |
|------|------|------|------|-------------|-----------|
| 12,5 | 20.5 | 2    | 5    | HL Board O6 | 178509    |
| 15,5 | 20.5 | 2    | 5    | HL Board O6 | 178510    |
| 15,5 | 25.5 | 2    | 5    | HL Board O6 | 178511    |
| 16,4 | 20.5 | 2    | 5    | HL Board O6 | 178512    |
| 16,7 | 25.9 | 2    | 5    | HL Board O6 | 178513    |
| 18,4 | 18.9 | 2    | 5    | HL Board O6 | 178514    |
| 18,4 | 25.9 | 2    | 5    | HL Board O6 | 178515    |
| 18,4 | 36.3 | 2    | 5    | HL Board O6 | 178516    |
| 20,3 | 20.5 | 2    | 5    | HL Board O6 | 178517    |
| 20,3 | 25.5 | 2    | 5    | HL Board O6 | 178518    |
| 20,3 | 30.4 | 2    | 5    | HL Board O6 | 178519    |
| 22,3 | 25.5 | 2    | 5    | HL Board O6 | 178520    |
| [mm] | [mm] | [mm] | [mm] |             |           |

## Blanks

| B    | H    | S    | Ø d  | LEUCODUR    | Ident-No. |
|------|------|------|------|-------------|-----------|
| 24,3 | 20,9 | 2    | 5    | HL Board 06 | 178521    |
| 24,3 | 28,4 | 2    | 5    | HL Board 06 | 178522    |
| 25,3 | 25,9 | 2    | 5    | HL Board 06 | 178523    |
| 25,3 | 35,3 | 2    | 5    | HL Board 06 | 178524    |
| 28,2 | 25,5 | 2    | 5    | HL Board 06 | 178525    |
| 28,2 | 35,3 | 2    | 5    | HL Board 06 | 178526    |
| 12,5 | 20,5 | 2    | 5    | HL Solid 60 | 179509    |
| 15,5 | 20,5 | 2    | 5    | HL Solid 60 | 179510    |
| 15,5 | 25,5 | 2    | 5    | HL Solid 60 | 179511    |
| 16,4 | 20,5 | 2    | 5    | HL Solid 60 | 179512    |
| 16,7 | 25,9 | 2    | 5    | HL Solid 60 | 179513    |
| 18,4 | 18,9 | 2    | 5    | HL Solid 60 | 179514    |
| 18,4 | 25,9 | 2    | 5    | HL Solid 60 | 179515    |
| 18,4 | 36,3 | 2    | 5    | HL Solid 60 | 179516    |
| 20,3 | 20,5 | 2    | 5    | HL Solid 60 | 179517    |
| 20,3 | 25,5 | 2    | 5    | HL Solid 60 | 179518    |
| 20,3 | 30,4 | 2    | 5    | HL Solid 60 | 179519    |
| 22,3 | 25,5 | 2    | 5    | HL Solid 60 | 179520    |
| 24,3 | 20,9 | 2    | 5    | HL Solid 60 | 179521    |
| 24,3 | 28,4 | 2    | 5    | HL Solid 60 | 179522    |
| 25,3 | 25,9 | 2    | 5    | HL Solid 60 | 179523    |
| 25,3 | 35,3 | 2    | 5    | HL Solid 60 | 179524    |
| 28,2 | 25,5 | 2    | 5    | HL Solid 60 | 179525    |
| 28,2 | 35,3 | 2    | 5    | HL Solid 60 | 179526    |
| [mm] | [mm] | [mm] | [mm] |             |           |

152586 / 152589

## 3P Blanks

Product

Drawing

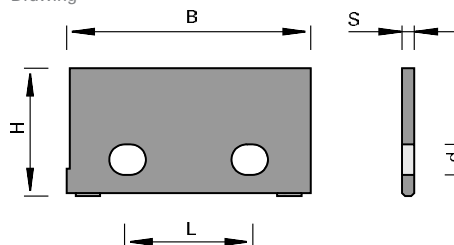

LEUCODUR

Tungsten Carbide [HW]

Machine / Application

| for use in LEUCO EcoPro and special cutterheads

Design

| two-point seating surface and point-stop  
 | cutting material: HW  
 | HL Board 06 for wood-based panels, plastics and soft woods  
 | HL Solid 60 for soft woods

Advantages

| precise positioning of the blanks for profiling and of the single-sided profile knife in the cutterhead

Notes

| profile knife can be profiled per customer specifications  
 | packing unit: 10 pieces

| B    | H    | S    | Ø d  | L           | LEUCODUR    | Ident-No. |
|------|------|------|------|-------------|-------------|-----------|
| 30,2 | 25,5 | 2    | 5    | 11,8 - 13,8 | HL Board 06 | 178527    |
| 30,2 | 30,4 | 2    | 5    | 11,8 - 13,8 | HL Board 06 | 178528    |
| 32,2 | 22,8 | 2    | 5    | 11,8 - 13,8 | HL Board 06 | 178529    |
| 32,2 | 35,4 | 2    | 5    | 11,8 - 13,8 | HL Board 06 | 178530    |
| 32,8 | 47,2 | 2    | 5    | 11,8 - 13,8 | HL Board 06 | 178531    |
| 35,2 | 26   | 2    | 5    | 11,8 - 13,8 | HL Board 06 | 178532    |
| 40,1 | 20,9 | 2    | 5    | 21,7 - 25,5 | HL Board 06 | 178533    |
| 40,1 | 30,4 | 2    | 5    | 21,7 - 25,5 | HL Board 06 | 178534    |
| 40,8 | 36   | 2    | 5    | 21,7 - 25,5 | HL Board 06 | 178535    |
| 42,8 | 31   | 2    | 5    | 21,7 - 25,5 | HL Board 06 | 178536    |
| 42,8 | 36   | 2    | 5    | 21,7 - 25,5 | HL Board 06 | 178537    |
| 45,8 | 36   | 2    | 5    | 21,7 - 25,5 | HL Board 06 | 178538    |
| 49,9 | 20,9 | 2    | 5    | 21,7 - 25,5 | HL Board 06 | 178539    |
| [mm] | [mm] | [mm] | [mm] | [mm]        |             |           |

| B    | H    | S    | Ø d  | L           | LEUCODUR    | Ident-No. |
|------|------|------|------|-------------|-------------|-----------|
| 49,9 | 33   | 2    | 5    | 21,7 - 25,5 | HL Board 06 | 178540    |
| 49,9 | 40,2 | 2    | 5    | 21,7 - 25,5 | HL Board 06 | 178541    |
| 60,6 | 25,8 | 2    | 5    | 26 - 22     | HL Board 06 | 178542    |
| 59,8 | 35,4 | 2    | 5    | 25,5 + 43,2 | HL Board 06 | 178543    |
| 80,6 | 35,8 | 2    | 5    | 44          | HL Board 06 | 178544    |
| 30,2 | 25,5 | 2    | 5    | 11,8 - 13,8 | HL Solid 60 | 179527    |
| 30,2 | 30,4 | 2    | 5    | 11,8 - 13,8 | HL Solid 60 | 179528    |
| 32,2 | 22,8 | 2    | 5    | 11,8 - 13,8 | HL Solid 60 | 179529    |
| 32,2 | 35,4 | 2    | 5    | 11,8 - 13,8 | HL Solid 60 | 179530    |
| 32,8 | 47,2 | 2    | 5    | 11,8 - 13,8 | HL Solid 60 | 179531    |
| 35,2 | 26   | 2    | 5    | 11,8 - 13,8 | HL Solid 60 | 179532    |
| 40,1 | 20,9 | 2    | 5    | 21,7 - 25,5 | HL Solid 60 | 179533    |
| 40,1 | 30,4 | 2    | 5    | 21,7 - 25,5 | HL Solid 60 | 179534    |
| 40,8 | 36   | 2    | 5    | 21,7 - 25,5 | HL Solid 60 | 179535    |
| 42,8 | 31   | 2    | 5    | 21,7 - 25,5 | HL Solid 60 | 179536    |
| 42,8 | 36   | 2    | 5    | 21,7 - 25,5 | HL Solid 60 | 179537    |
| 45,8 | 36   | 2    | 5    | 21,7 - 25,5 | HL Solid 60 | 179538    |
| 49,9 | 20,9 | 2    | 5    | 21,7 - 25,5 | HL Solid 60 | 179539    |
| 49,9 | 33   | 2    | 5    | 21,7 - 25,5 | HL Solid 60 | 179540    |
| 49,2 | 40,2 | 2    | 5    | 21,7 - 25,5 | HL Solid 60 | 179541    |
| 60,6 | 25,8 | 2    | 5    | 26 - 22     | HL Solid 60 | 179542    |
| 59,8 | 35,4 | 2    | 5    | 25,5 + 43,2 | HL Solid 60 | 179543    |
| 80,6 | 35,8 | 2    | 5    | 44          | HL Solid 60 | 179544    |
| [mm] | [mm] | [mm] | [mm] | [mm]        |             |           |

152786

### 3P Blanks

Product

Drawing

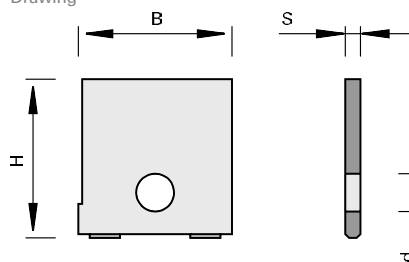

LEUCO  
topline

LEUCO  
DUR

Tungsten Carbide [HW]

Machine / Application

l for use in LEUCO EcoPro and special cutterheads

Design

l two-point seating surface and point-stop  
l cutting material: HW  
l HL Board 06 for wood-based panels, plastics and soft woods  
l Topline (polished surface)

Advantages

l long edge life and optimum cutting quality thanks to TOPLINE design  
l precise positioning of the blanks for profiling and of the single-sided profile knife in the cutterhead

Notes

l figure shows left hand design, top view, polished  
l profile knife can be profiled per customer specifications  
l packing unit: 10 pieces

| B    | H    | S    | Ø d  | Ident-No. [L] | Ident-No. [R] |
|------|------|------|------|---------------|---------------|
| 12,5 | 20,5 | 2    | 5    | 179547&       | 179548        |
| 15,5 | 20,5 | 2    | 5    | 179549&       | 179550&       |
| 15,5 | 25,5 | 2    | 5    | 179551&       | 179552&       |
| 16,4 | 20,5 | 2    | 5    | 179553&       | 179554&       |
| 16,7 | 25,9 | 2    | 5    | 179555&       | 179556&       |
| 18,4 | 18,9 | 2    | 5    | 179557&       | 179558&       |
| 18,4 | 25,9 | 2    | 5    | 179559&       | 179560&       |
| 18,4 | 36,3 | 2    | 5    | 179561&       | 179562&       |
| 20,3 | 20,5 | 2    | 5    | 179563&       | 179564&       |
| 20,3 | 25,5 | 2    | 5    | 179565&       | 179566&       |
| 20,3 | 30,4 | 2    | 5    | 179567&       | 179568&       |
| 22,3 | 25,5 | 2    | 5    | 179569&       | 179570&       |
| 24,3 | 20,9 | 2    | 5    | 179571&       | 179572&       |
| [mm] | [mm] | [mm] | [mm] |               |               |

## Blanks

| B    | H    | S    | Ø d  | Ident-No. [L] | Ident-No. [R] |
|------|------|------|------|---------------|---------------|
| 24,3 | 28.4 | 2    | 5    | 1795738       | 1795748       |
| 25,3 | 25.9 | 2    | 5    | 179575        | 179576        |
| 25,3 | 35.3 | 2    | 5    | 1795778       | 1795788       |
| 28,2 | 25.5 | 2    | 5    | 179579        | 179580        |
| 28,2 | 35.3 | 2    | 5    | 1795818       | 1795828       |
| [mm] | [mm] | [mm] | [mm] |               |               |

152789

### 3P Blanks

Product

Drawing

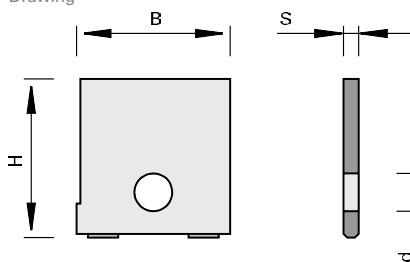

LEUCO  
topline

LEUCO  
DUR

Tungsten Carbide [HW]

Machine / Application

for use in LEUCO EcoPro and special cutterheads

Design

two-point seating surface and point-stop  
cutting material: HW  
HL Solid 60 for soft woods  
Topline (polished surface)

Advantages

long edge life and optimum cutting quality thanks to TOPLINE design  
precise positioning of the blanks for profiling and of the single-sided profile knife in the cutterhead

Notes

figure shows left hand design, top view, polished  
profile knife can be profiled per customer specifications  
packing unit: 10 pieces

| B    | H    | S    | Ø d  | Ident-No. [L] | Ident-No. [R] |
|------|------|------|------|---------------|---------------|
| 12,5 | 20.5 | 2    | 5    | 1796218       | 1796228       |
| 15,5 | 20.5 | 2    | 5    | 1796238       | 1796248       |
| 15,5 | 25.5 | 2    | 5    | 1796258       | 1796268       |
| 16,4 | 20.5 | 2    | 5    | 1796278       | 1796288       |
| 16,7 | 25.9 | 2    | 5    | 1796298       | 1796308       |
| 18,4 | 18.9 | 2    | 5    | 1796318       | 1796328       |
| 18,4 | 25.9 | 2    | 5    | 1796338       | 1796348       |
| 18,4 | 36.3 | 2    | 5    | 1796358       | 1796368       |
| 20,3 | 20.5 | 2    | 5    | 1796378       | 1796388       |
| 20,3 | 25.5 | 2    | 5    | 1796398       | 1796408       |
| 20,3 | 30.4 | 2    | 5    | 1796418       | 1796428       |
| 22,3 | 25.5 | 2    | 5    | 1796438       | 1796448       |
| 24,3 | 20.9 | 2    | 5    | 1796458       | 1796468       |
| 24,3 | 28.4 | 2    | 5    | 1796478       | 1796488       |
| 25,3 | 25.9 | 2    | 5    | 1796498       | 1796508       |
| 25,3 | 35.3 | 2    | 5    | 1796518       | 1796528       |
| 28,2 | 25.5 | 2    | 5    | 1796538       | 1796548       |
| 28,2 | 35.3 | 2    | 5    | 1796558       | 1796568       |
| [mm] | [mm] | [mm] | [mm] |               |               |

152786

## 3P Blanks

Product

Drawing

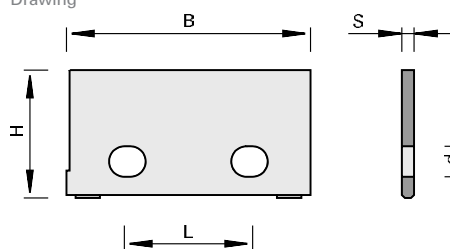
LEUCO  
toplineLEUCO  
DUR

Tungsten Carbide [HW]

Machine / Application

l for use in LEUCO EcoPro and special cutterheads

Design

l two-point seating surface and point-stop  
l cutting material: HW  
l HL Board O6 for wood-based panels, plastics and soft woods  
l Topline (polished surface)

Advantages

l long edge life and optimum cutting quality thanks to TOPLINE design  
l precise positioning of the blanks for profiling and of the single-sided profile knife in the cutterhead

Notes

l figure shows left hand design, top view, polished  
l profile knife can be profiled per customer specifications  
l packing unit: 10 pieces

| B    | H    | S    | Ø d  | L           | Ident-No. [L] | Ident-No. [R] |
|------|------|------|------|-------------|---------------|---------------|
| 30,2 | 25,5 | 2    | 5    | 11,8 - 13,8 | 179583&       | 179584&       |
| 30,2 | 30,4 | 2    | 5    | 11,8 - 13,8 | 179585&       | 179586&       |
| 32,2 | 22,8 | 2    | 5    | 11,8 - 13,8 | 179587&       | 179588&       |
| 32,2 | 35,4 | 2    | 5    | 11,8 - 13,8 | 179589&       | 179590&       |
| 32,8 | 47,2 | 2    | 5    | 11,8 - 13,8 | 179591&       | 179592&       |
| 35,2 | 26   | 2    | 5    | 11,8 - 13,8 | 179593        | 179594        |
| 40,1 | 20,9 | 2    | 5    | 21,7 - 25,5 | 179595&       | 179596&       |
| 40,1 | 30,4 | 2    | 5    | 21,7 - 25,5 | 179597&       | 179598&       |
| 40,8 | 36   | 2    | 5    | 21,7 - 25,5 | 179599&       | 179600&       |
| 42,8 | 31   | 2    | 5    | 21,7 - 25,5 | 179601&       | 179602&       |
| 42,8 | 36   | 2    | 5    | 21,7 - 25,5 | 179603&       | 179604&       |
| 45,8 | 36   | 2    | 5    | 21,7 - 25,5 | 179605&       | 179606&       |
| 49,9 | 20,9 | 2    | 5    | 21,7 - 25,5 | 179607&       | 179608&       |
| 49,9 | 33   | 2    | 5    | 21,7 - 25,5 | 179609&       | 179610&       |
| 49,9 | 40,2 | 2    | 5    | 21,7 - 25,5 | 179611&       | 179612&       |
| 60,6 | 25,8 | 2    | 5    | 22 - 26     | 179613&       | 179614&       |
| 59,8 | 35,4 | 2    | 5    | 25,5 + 43,2 | 179615&       | 179616&       |
| 80,6 | 35,8 | 2    | 5    | 44          | 179617&       | 179618&       |
| [mm] | [mm] | [mm] | [mm] | [mm]        |               |               |

152789

## 3P Blanks

Product

Drawing

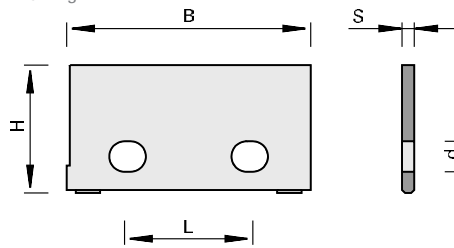
LEUCO  
toplineLEUCO  
DUR

Tungsten Carbide [HW]

Machine / Application

l for use in LEUCO EcoPro and special cutterheads

Design

l two-point seating surface and point-stop  
l cutting material: HW  
l HL Solid 60 for soft woods  
l Topline (polished surface)

Advantages

l long edge life and optimum cutting quality thanks to TOPLINE design  
l precise positioning of the blanks for profiling and of the single-sided profile knife in the cutterhead

Notes

l figure shows left hand design, top view, polished  
l profile knife can be profiled per customer specifications  
l packing unit: 10 pieces

| B    | H    | S    | Ø d  | L           | Ident-No. [L] | Ident-No. [R] |
|------|------|------|------|-------------|---------------|---------------|
| 30,2 | 25.5 | 2    | 5    | 11,8 - 13,8 | 179657        | 179658        |
| 30,2 | 30.4 | 2    | 5    | 11,8 - 13,8 | 179659        | 179660        |
| 32,2 | 22.8 | 2    | 5    | 11,8 - 13,8 | 179661        | 179662        |
| 32,2 | 35.4 | 2    | 5    | 11,8 - 13,8 | 179663        | 179664        |
| 32,8 | 47.2 | 2    | 5    | 11,8 - 13,8 | 179665        | 179666        |
| 35,2 | 26   | 2    | 5    | 11,8 - 13,8 | 179667        | 179668        |
| 40,1 | 20.9 | 2    | 5    | 21,7 - 25,5 | 179669        | 179670        |
| 40,1 | 30.4 | 2    | 5    | 21,7 - 25,5 | 179671        | 179672        |
| 40,8 | 36   | 2    | 5    | 21,7 - 25,5 | 179673        | 179674        |
| 42,8 | 31   | 2    | 5    | 21,7 - 25,5 | 179675        | 179676        |
| 42,8 | 36   | 2    | 5    | 21,7 - 25,5 | 179677        | 179678        |
| 45,8 | 36   | 2    | 5    | 21,7 - 25,5 | 179679        | 179680        |
| 49,9 | 20.9 | 2    | 5    | 21,7 - 25,5 | 179681        | 179682        |
| 49,9 | 33   | 2    | 5    | 21,7 - 25,5 | 179683        | 179684        |
| 49,9 | 40.2 | 2    | 5    | 21,7 - 25,5 | 179685        | 179686        |
| 60,6 | 25.8 | 2    | 5    | 22 - 26     | 179687        | 179688        |
| 59,8 | 35.4 | 2    | 5    | 25,5 + 43,2 | 179689        | 179690        |
| 80,6 | 35.8 | 2    | 5    | 44          | 179691        | 179692        |
| [mm] | [mm] | [mm] | [mm] | [mm]        |               |               |



152526 / 152529

## SuperProfiler Blanks

Product

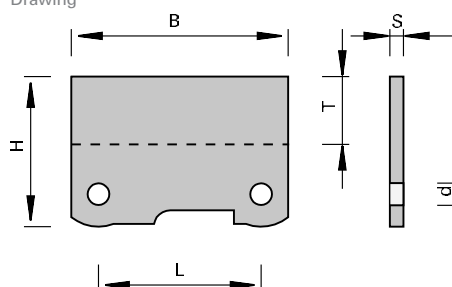

Drawing

LEUCO  
DUR

Tungsten Carbide [HW]

Machine / Application

| for use in LEUCO SuperProfiler  
cutterheads

Design

| thickness ground  
| cutting material: HW  
| HL Board 06 for wood-based  
panels, plastics and soft woods  
| HL Solid 60 for soft woods

Advantages

Notes

| for concave and convex  
profiles  
| T = maximum profile depth

| B    | H    | S    | Ø d  | L       | Tmax | LEUCODUR    | Ident-No. |
|------|------|------|------|---------|------|-------------|-----------|
| 30,6 | 25,5 | 1,5  | 4    | 16 - 20 | 13   | HL Board 06 | 179114    |
| 30,6 | 25,5 | 1,5  | 4    | 16 - 20 | 13   | HL Solid 60 | 177369    |
| 40,6 | 28,2 | 1,5  | 4    | 28      | 13   | HL Board 06 | 179112    |
| 40,6 | 28,2 | 1,5  | 4    | 28      | 13   | HL Solid 60 | 177367    |
| 40,6 | 40,6 | 2    | 5    | 28      | 20   | HL Board 06 | 179115    |
| 40,6 | 40,6 | 2    | 5    | 28      | 20   | HL Solid 60 | 178844    |
| 49,3 | 33,7 | 1,5  | 4    | 35      | 16   | HL Board 06 | 180199    |
| 60,8 | 30,2 | 1,5  | 4    | 48      | 15   | HL Board 06 | 179113    |
| 60,8 | 30,2 | 1,5  | 4    | 48      | 15   | HL Solid 60 | 177368    |
| 60,6 | 45,6 | 2    | 5    | 45      | 25   | HL Board 06 | 179999    |
| 60,6 | 45,6 | 2    | 5    | 45      | 25   | HL Solid 60 | 178845    |
| 80,6 | 45,6 | 2    | 6    | 65      | 25   | HL Board 06 | 180016    |
| 80,6 | 45,6 | 2    | 6    | 65      | 25   | HL Solid 60 | 180017    |
| [mm] | [mm] | [mm] | [mm] | [mm]    | [mm] |             |           |

152726 / 152729

## SuperProfiler Blanks

Product

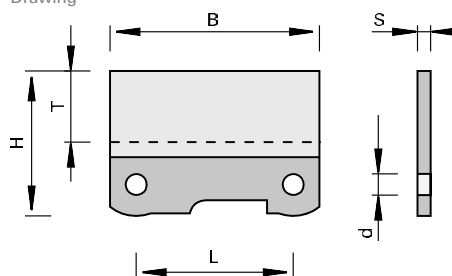

Drawing

LEUCO  
toplineLEUCO  
DUR

Tungsten Carbide [HW]

Machine / Application

| for use in LEUCO SuperProfiler  
cutterheads

Design

| Topline (polished surface)  
| cutting material: HW  
| HL Board 06 for wood-based  
panels, plastics and soft woods  
| HL Solid 60 for soft woods

Advantages

| significantly improved cutting  
edges  
| optimum edge lives  
| optimum quality of cut

Notes

| T = maximum profile depth

| B    | H    | S    | Ø d  | L       | Tmax | LEUCODUR    | Ident-No. [L] | Ident-No. [R] |
|------|------|------|------|---------|------|-------------|---------------|---------------|
| 30,6 | 25,5 | 1,5  | 4    | 16 - 20 | 13   | HL Board 06 | 178701        | 178702        |
| 30,6 | 25,5 | 1,5  | 4    | 16 - 20 | 13   | HL Solid 60 | 177789        | 177790        |
| 40,6 | 28,2 | 1,5  | 4    | 28      | 13   | HL Board 06 | 178627        | 178626        |
| 40,6 | 28,2 | 1,5  | 4    | 28      | 13   | HL Solid 60 | 177791        | 177808        |
| [mm] | [mm] | [mm] | [mm] | [mm]    | [mm] |             |               |               |

## Blanks

| B    | H    | S    | Ø d  | L    | Tmax | LEUCODUR    | Ident-No. [L] | Ident-No. [R] |
|------|------|------|------|------|------|-------------|---------------|---------------|
| 40,6 | 40,6 | 2    | 5    | 28   | 20   | HL Board 06 | 180030&       | 180031        |
| 40,6 | 40,6 | 2    | 5    | 28   | 20   | HL Solid 60 | 180032&       | 180033        |
| 49,3 | 33,7 | 1,5  | 4    | 35   | 16   | HL Board 06 | 180208        | 180209        |
| 60,8 | 30,2 | 1,5  | 4    | 48   | 15   | HL Board 06 | 178643        | 178628        |
| 60,8 | 30,2 | 1,5  | 4    | 48   | 15   | HL Solid 60 | 177809        | 177810        |
| 60,6 | 45,6 | 2    | 5    | 45   | 25   | HL Board 06 | 180034        | 180035        |
| 60,6 | 45,6 | 2    | 5    | 45   | 25   | HL Solid 60 | 180040&       | 180041        |
| 80,6 | 45,6 | 2    | 6    | 65   | 25   | HL Board 06 | 180042        | 180043        |
| 80,6 | 45,6 | 2    | 6    | 65   | 25   | HL Solid 60 | 180044        | 180045        |
| [mm] | [mm] | [mm] | [mm] | [mm] | [mm] |             |               |               |

152726

## SuperProfiler Blanks

Product

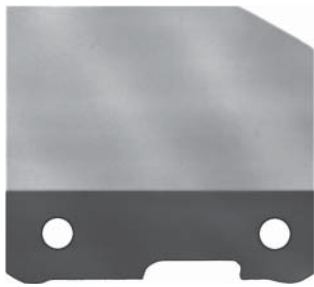

Drawing

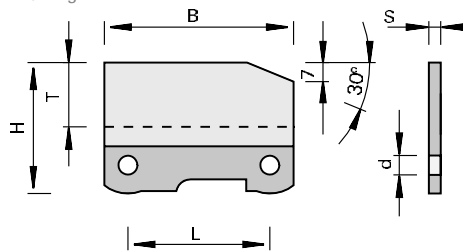

LEUCO  
topline

LEUCO  
DUR

Tungsten Carbide [HW]

Machine / Application

| for use in LEUCO SuperProfiler cutterheads

Design

| Topline (polished surface)  
| cutting material: HW  
| HL Board 06 for wood-based panels, plastics and soft woods

Advantages

| significantly improved cutting edges  
| optimum edge lives  
| optimum quality of cut

Notes

| T = maximum profile depth  
| figure shows right hand design, top view, polished

| B    | H    | S    | Ø d  | L    | Tmax | Ident-No. [L] | Ident-No. [R] |
|------|------|------|------|------|------|---------------|---------------|
| 49,4 | 44,5 | 2    | 5    | 35   | 22   | 180219        | 180220        |
| [mm] | [mm] | [mm] | [mm] | [mm] | [mm] |               |               |

152526

## SuperProfiler Blanks

Product

Drawing

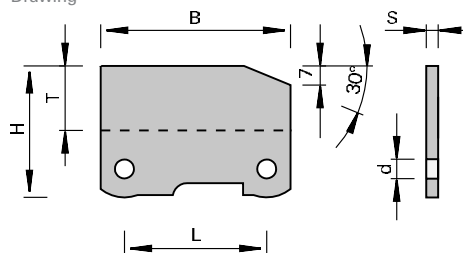

LEUCO  
DUR

Tungsten Carbide [HW]

Machine / Application

| for use in LEUCO SuperProfiler cutterheads

Design

| cutting material: HW  
| HL Board 06 for wood-based panels, plastics and soft woods

Advantages

Notes

| T = maximum profile depth

| B    | H    | S    | Ø d  | L    | Tmax | Ident-No. |
|------|------|------|------|------|------|-----------|
| 49,4 | 44,5 | 2    | 5    | 35   | 22   | 180218    |
| [mm] | [mm] | [mm] | [mm] | [mm] | [mm] |           |

152536

## PolyProfiler / EcoPro Blanks

Product

Drawing

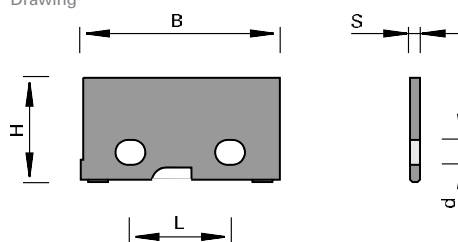
LEUCO  
DUR

Tungsten Carbide [HW]

Machine / Application

for use in LEUCO PolyProfiler and EcoPro cutterheads

Design

two-point seating surface and center stop for axial positioning  
cutting material: HW  
HL Board O6 for wood-based panels, plastics and soft woods

Advantages

precise positioning of the blanks for profiling and of the single-sided profile knife in the cutterhead

Notes

profile knife can be profiled per customer specifications  
packing unit: 10 pieces

| B          | H            | S         | Ø d       | L                 | Ident-No. |
|------------|--------------|-----------|-----------|-------------------|-----------|
| 41<br>[mm] | 32.5<br>[mm] | 2<br>[mm] | 5<br>[mm] | 21,7-25,5<br>[mm] | 180197    |

152536

## PolyProfiler / EcoPro Blanks

Product

Drawing

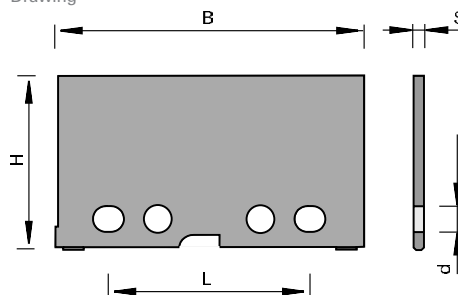
LEUCO  
DUR

Tungsten Carbide [HW]

Machine / Application

for use in LEUCO PolyProfiler and EcoPro cutterheads

Design

two-point seating surface and center stop for axial positioning  
cutting material: HW  
HL Board O6 for wood-based panels, plastics and soft woods

Advantages

precise positioning of the blanks for profiling and of the single-sided profile knife in the cutterhead

Notes

profile knife can be profiled per customer specifications  
packing unit: 10 pieces

| B          | H          | S         | Ø d       | L                 | Ident-No. |
|------------|------------|-----------|-----------|-------------------|-----------|
| 61<br>[mm] | 34<br>[mm] | 2<br>[mm] | 5<br>[mm] | 41,7-45,5<br>[mm] | 180198    |